

# Super Smart Ball Bushing™ Flanged Single and Twin Pillow Blocks

for End-Supported Application

## Single Pillow Block

### SINGLE PILLOW BLOCKS

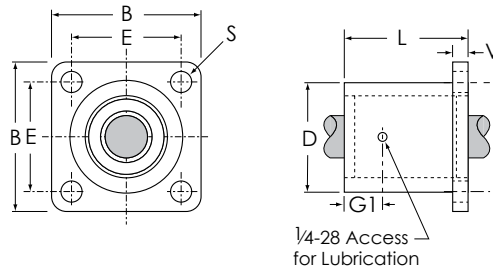

Super Smart Ball Bushing™ Flanged Single Pillow Blocks (Dimensions in inches)										
Catalog Number	Nominal Diameter	B	E ± .010	L	D	V	G1	S Hole Dia.	Pillow Block Mass lb	Dynamic <sup>A</sup> Load Capacity lbf
TSS6UFB-8	.500	1.63	1.250	1.69	1.25	.25	.72	.19	.23	265
TSSUFB-12	.750	2.38	1.750	2.06	1.75	.38	.89	.22	.52	1130
TSSUFB-16	1.000	2.75	2.125	2.81	2.25	.50	1.27	.28	1.04	1900
TSSUFB-20	1.250	3.50	2.750	3.63	3.00	.63	1.67	.35	2.34	2350
TSSUFB-24	1.500	4.00	3.125	4.00	3.62	.75	1.86	.41	3.69	3880

<sup>A</sup>See the chart on the bottom half of the next page.

**NOTE:** Catalog number is for a standard item.

For other options, add: **CR** Corrosion-Resistant, **NB** Nylon Balls, or **CM** Ceramic Balls to end of catalog number.

## Twin Pillow Block

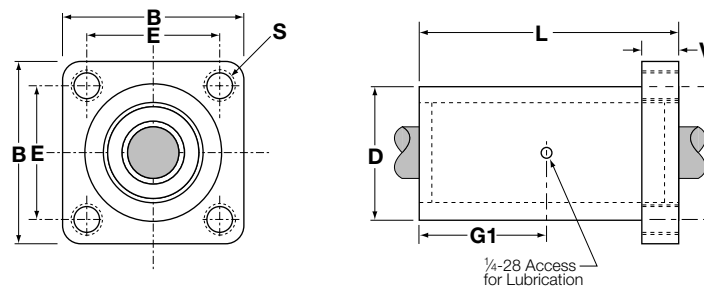

Super Smart Ball Bushing™ Flanged Twin Pillow Blocks (Dimensions in inches)										
Catalog Number	Nominal Diameter	B	E ± .010	L	D	V	G1	S Thread	Pillow Block Mass lb	Dynamic <sup>A</sup> Load Capacity lbf
TSS6UTFB-8	.500	1.63	1.250	3.20	1.25	.90	1.48	1/4-20	.45	530
TSSUTFB-12	.750	2.38	1.750	3.95	1.75	.90	1.98	1/4-20	1.05	2260
TSSUTFB-16	1.000	2.75	2.125	5.33	2.25	.90	2.67	5/16-18	1.95	3800
TSSUTFB-20	1.250	3.50	2.750	6.70	3.00	.90	3.35	5/16-18	4.20	4700
TSSUTFB-24	1.500	4.00	3.125	7.50	3.62	1.00	3.75	3/8-16	6.81	7760

<sup>A</sup>See the chart on the bottom half of the next page.

Continued on the next page

**NOTE:** Catalog number is for a standard item.

For other options, add: **CR** Corrosion-Resistant, **NB** Nylon Balls, or **CM** Ceramic Balls to end of catalog number.