

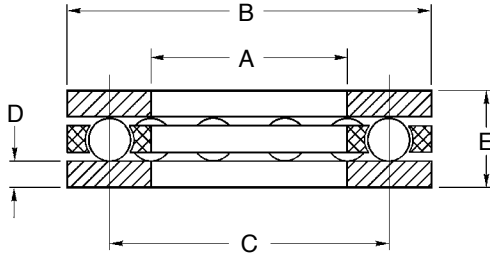

Three-Piece Set THRUST BEARINGS & WASHERS

- Nylon Retainer



Materials

	Carbon Steel	Stainless Steel
Washer:	CR 1075 steel heat-treated to Rc 59-61	Type 410 steel heat-treated to Rc 38-42
Ball:	Grade 100 S.A.E. 1018 steel with Rc 60 Minimum	Type 440C stainless steel with Rc 58-65
Retainer:	HS nylon permitting continuous use up to 250°F	HS nylon permitting continuous use up to 250°F

Catalog Number		A		B		D Thick- ness	C Ball Circle	Ball Size	Qty	E Height
		Bore	Tolerance	O.D.	Tolerance					
Carbon Steel	Stainless Steel	Washer				Ball			Bearing	
BTHASY-012	BTYASY-012	1/8	.128 - .133	7/16	.430 - .437	.050	.281	.0938	6	.190-.196
BTHASY-018	BTYASY-018	3/16	.191 - .195	1/2	.492 - .499		.344			
BTHASY-025	BTYASY-025	1/4	.253 - .258	9/16	.555 - .562		.406			
BTHASY-031	BTYASY-031	5/16	.316 - .321	5/8	.617 - .624	.062	.469	9		
BTHASY-037	BTYASY-037	3/8	.378 - .383	13/16	.805 - .812		.594			
BTHASY-043	BTYASY-043	7/16	.441 - .446	7/8	.867 - .874		.656			
BTHASY-050	BTYASY-050	1/2	.503 - .508	15/16	.930 - .937	.093	.719	8	.245-.253	
BTHASY-056	BTYASY-056	9/16	.566 - .571	1	.992 - .999		.781			
BTHASY-062	BTYASY-062	5/8	.628 - .635	1-1/8	1.115-1.124		.875			
BTHASY-068	BTYASY-068	11/16	.691 - .698	1-3/16	1.178-1.187	.125	.938	7		
BTHASY-075	BTYASY-075	3/4	.753 - .760	1-1/4	1.240-1.249		1.000			
BTHASY-081	BTYASY-081	13/16	.816 - .823	1-5/16	1.303-1.312		1.063			
BTHASY-087	BTYASY-087	7/8	.878 - .885	1-3/8	1.365-1.374	.125	1.125	10		
BTHASY-093	BTYASY-093	15/16	.941 - .950	1-9/16	1.551-1.562		1.250			
BTHASY-100	BTYASY-100	1	1.003-1.012	1-5/8	1.613-1.624		1.313			
BTHASY-112	BTYASY-112	1-1/8	1.128-1.137	1-3/4	1.738-1.749	.125	1.438	12	.427-.447	
BTHASY-125	BTYASY-125	1-1/4	1.253-1.262	1-7/8	1.863-1.874		1.563			
BTHASY-150	BTYASY-150	1-1/2	1.503-1.512	2-1/8	2.113-2.124		1.813			

NOTE: Thrust bearings and washers are available individually.
Contact the Customer Service Department for availability.

See page 59 for load ratings.

WASHER THICKNESS TOLERANCE

D	Tolerance
.050	.048 - .052
.062	.060 - .064
.093	.090 - .096
.125	.120 - .130