

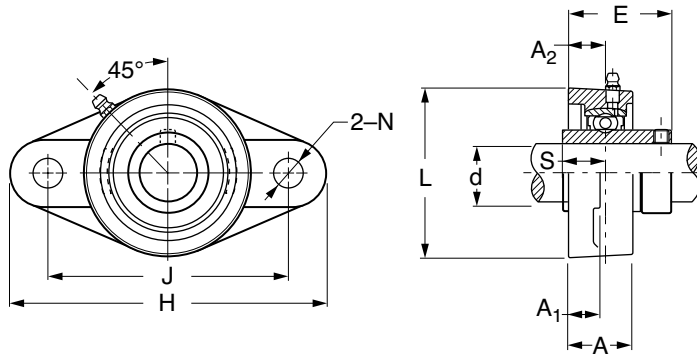

NEW

**Standard Duty Two-Bolt Flange Mounting Blocks
SET SCREW TYPE**

• Cast Iron Housing • Dual Seal Type



Catalog Number	Ød Shaft	H	J	L	A ₂	A ₁	A	E	N	S	Bolt Size	Weight lb.
BBXBLK-UFL2018S	1/2											
BBXBLK-UFL20210S	5/8	3-29/32	3	2-1/4	19/32	7/16	1	1-7/32	7/16	7/16	3/8	.99
BBXBLK-UFL20311S	11/16											
BBXBLK-UFL20412	3/4	4-7/16	3-9/16	2-3/8	19/32	7/16	1	1-5/16	7/16	1/2	3/8	1.12
BBXBLK-UFL20514	7/8											
BBXBLK-UFL20515	15/16	5-1/8	3-29/32	2-11/16	5/8	17/32	1-1/16	1-13/32	7/16	9/16	3/8	1.32
BBXBLK-UFL20516	1											
BBXBLK-UFL20618	1-1/8											
BBXBLK-UFL20619	1-3/16	5-27/32	4-5/8	3-5/32	23/32	17/32	1-7/32	1-19/32	7/16	5/8	3/8	1.98
BBXBLK-UFL20620	1-1/4											
BBXBLK-UFL20720	1-1/4											
BBXBLK-UFL20721	1-5/16	6-11/32	5-1/8	3-9/16	3/4	9/16	1-11/32	1-3/4	9/16	11/16	1/2	2.64
BBXBLK-UFL20722	1-3/8											
BBXBLK-UFL20723	1-7/16											
BBXBLK-UFL20824	1-1/2	6-7/8	5-11/16	3-15/16	27/32	9/16	1-7/16	2-1/32	9/16	3/4	1/2	3.30
BBXBLK-UFL20825	1-9/16											
BBXBLK-UFL20926	1-5/8											
BBXBLK-UFL20927	1-11/16	7-13/32	5-27/32	4-1/4	7/8	5/8	1-1/2	2-1/16	23/32	3/4	5/8	4.18
BBXBLK-UFL20928	1-3/4											
BBXBLK-UFL21030	1-7/8											
BBXBLK-UFL21031	1-15/16	7-3/4	6-3/16	4-17/32	7/8	5/8	1-19/32	2-5/32	23/32	3/4	5/8	4.85
BBXBLK-UFL21032	2											
BBXBLK-UFL21132	2											
BBXBLK-UFL21134	2-1/8	8-13/16	7-1/4	5-1/8	1	23/32	1-11/16	2-5/16	23/32	7/8	5/8	6.83
BBXBLK-UFL21135	2-3/16											
BBXBLK-UFL21236	2-1/4											
BBXBLK-UFL21238	2-3/8	9-27/32	7-31/32	5-1/2	1-5/32	23/32	1-29/32	2-23/32	23/32	1	5/8	8.82
BBXBLK-UFL21239	2-7/16											
BBXBLK-UFL21340	2-1/2	10-5/32	8-9/32	6-3/32	1-3/16	25/32	1-31/32	2-3/4	29/32	1	3/4	11.20
BBXBLK-UFL21444	2-3/4	10-7/16	8-1/2	6-5/16	1-7/32	25/32	2-1/8	2-31/32	29/32	1-3/16	3/4	12.34
BBXBLK-UFL21547	2-15/16											
BBXBLK-UFL21548	3	10-27/32	8-7/8	6-15/32	1-11/32	7/8	2-3/16	3-3/32	29/32	1-5/16	3/4	13.66
BBXBLK-UFL21752	3-1/4	12	9-25/32	7-1/2	1-13/32	7/8	2-15/32	3-7/16	1	1-11/32	7/8	21.60
BBXBLK-UFL21856	3-1/2	12-19/32	10-7/16	8-1/16	1-19/32	29/32	2-11/16	3-13/16	1	1-9/16	7/8	27.33

NOTE: See page 82 for insert bearing data.