

ROUND HANDLES

PHONE: 516.328.3300 • FAX: 516.326.8827 • WWW.SDP-SI.COM

> MATERIAL:

Brass, Nickel Plated,
Stainless Steel or
Aluminum, Black Anodized

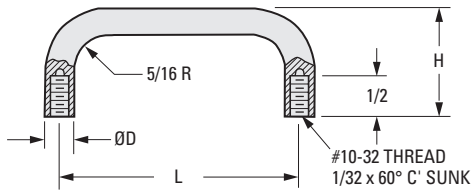

INCH COMPONENT

Catalog Number	H Height	L Length	D Dia.
Brass, Nickel Plated			
A 9B44-A3010	1-5/16	3	5/16
A 9B44-A4210	1-1/2	4-1/4	5/16
A 9B44-A4610	1-1/2	4-9/16	5/16
A 9B44-A6510	1-3/4	6-1/2	5/16
Stainless Steel			
A 9Y44-A30	1-5/16	3	5/16
A 9Y44-A30H	1-1/2	3	5/16
A 9Y44-A42	1-1/2	4-1/4	5/16
A 9Y44-A45	1-1/2	4-1/2	5/16
A 9Y44-A60	1-1/2	6	5/16
A 9Y44-A65	1-3/4	6-1/2	5/16
Aluminum, Black Anodized			
A 9A44-A30	1-1/2	3	5/16
*A 9A44-A40	1-7/8	4	3/8
A 9A44-A46	1-1/2	4-9/16	5/16

* Catalog number: A 9A44-A40 has an internal radius of 3/8".

END FERRULES

> MATERIAL:

Brass, Nickel Plated,
Aluminum, Black Anodized or
Stainless Steel

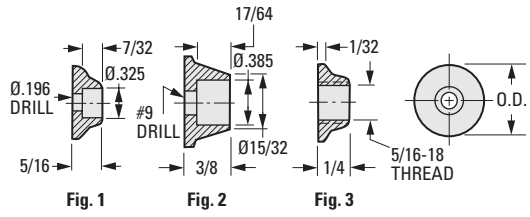

INCH COMPONENT

Catalog Number	Material	O.D.
Fig. 1		
A 9B44-A	Brass, Nickel Plated	3/4
A 9A44-A	Aluminum, Black Anodized	3/4
A 9Y44-A	Stainless Steel	3/4
Fig. 2		
A 9A44-AAA	Aluminum, Black Anodized	3/4
A 9B44-AAA	Brass, Nickel Plated	3/4
Fig. 3		
A 9B44-ATH	Brass, Nickel Plated	5/8