

STANDARD DESIGN

PHONE: 516.328.3300 • FAX: 516.326.8827 • WWW.SDP-SI.COM

> MATERIAL:

Alloy Steel

> SPECIFICATIONS:

Max. Working Angle - Power Driven Applications: 25°
 Hand Rotation Applications: 45°

Rating - Multiply design torque by correction factor obtained from following tables. Resulting number must be smaller than the breaking torque of the joint used.



Intermittent Running Conditions

Speed rpm	Angle of Operation - Degrees									
	0	3	5	7	10	15	20	25	30	
1800	9	20	34	45	—	—	—	—	—	
1500	8	16	28	39	—	—	—	—	—	
1200	7	13	22	32	40	—	—	—	—	
900	6	11	16	23	34	—	—	—	—	
600	5	8	11	15	22	34	40	—	—	
300	4	5	7	8	11	16	22	28	34	
100	3	4	4	5	6	8	9	11	12	

Running under load for less than 15 minutes.

Continuous Running Conditions

Speed rpm	Angle of Operation - Degrees									
	0	3	5	7	10	15	20	25	30	
1800	18	40	68	90	—	—	—	—	—	
1500	16	32	55	78	—	—	—	—	—	
1200	14	26	44	64	80	—	—	—	—	
900	12	21	32	46	68	—	—	—	—	
600	10	15	22	30	44	68	80	—	—	
300	8	10	14	16	22	32	44	55	68	
100	6	7	8	10	12	15	18	22	24	

Running under load from 15 minutes to 8 hours.

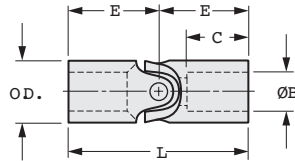

INCH COMPONENT

Catalog Number	O.D.	B Bore +.001 - .000	C Bore Depth ± 1/32	E	L Overall Length	Static Breaking Torque lbf in.	Approx. Weight lb.
Solid							
A 5Q 8-D100	3/8	—	—	7/8	1-3/4	110	.05
A 5Q 8-D200	1/2			1	2	378	.10
A 5Q 8-D300	5/8			1-1/8	2-1/4	540	.17
A 5Q 8-D400	3/4			1-11/32	2-11/16	768	.30
A 5Q 8-D500	7/8			1-1/2	3	1176	.45
Bored							
A 5Q 8-D106	3/8	.1875	9/16	7/8	1-3/4	110	.04
A 5Q 8-D108		.250					
A 5Q 8-D208	1/2	.250	5/8	1	2	378	.08
A 5Q 8-D210		.3125					
A 5Q 8-D212	5/8	.375	11/16	1-1/8	2-1/4	540	.15
A 5Q 8-D310		.3125					
A 5Q 8-D312	3/4	.375	7/8	1-11/32	2-11/16	768	.25
A 5Q 8-D314		.4375					
A 5Q 8-D316	7/8	.500	7/8	1-1/2	3	1176	.37
A 5Q 8-D412		.375					
A 5Q 8-D414	3/4	.4375	7/8	1-11/32	2-11/16	768	.25
A 5Q 8-D416		.500					
A 5Q 8-D514	7/8	.4375	7/8	1-1/2	3	1176	.37
A 5Q 8-D516		.500					

- I
- R
- T
- 1
- 2
- 3
- 4
- 5
- 6
- 7
- 8
- 9
- 10
- 11
- 12
- 13
- 14
- 15
- 16