

SINGLE & DOUBLE JOINTS
ZERO BACKLASH

PHONE: 516.328.3300 • FAX: 516.326.8827 • WWW.SDP-SI.COM

> MATERIAL:

Body - 303 Stainless Steel
Balls - 440 Stainless Steel

> LUBRICATION:

Dual protection, with sealed-in solid film plus oil suspension

> FEATURES:

Zero backlash through use of precision balls and burnished sockets
Sealed-in lubrication
Lightweight
Low inertia

> SPECIFICATIONS:

Maximum Operating Angle:

Single Joint: 30° at 4000 rpm
Double Joint: 60° at 4000 rpm

Torque Ratings:

For static conditions with in-line loading, maximum load being one which causes joint to yield.

These joints can be made into telescoping units by mating them with telescoping miniature ball splines:

S59PY5-... - pg. 4-24

S59PQ5-... - pg. 4-25

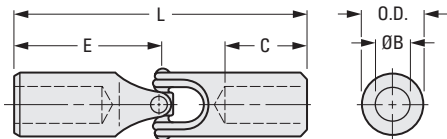

Fig. 1 Single Joint

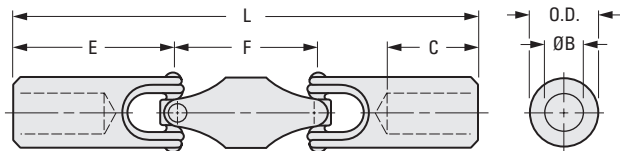

Fig. 2 Double Joint

INCH COMPONENT

Catalog Number	O.D.	B Bore +.0005 -.0000	C Bore Depth	E End Unit	F Center	L	Torque ozf in.
Fig. 1 Single Joint							
S57PY5-SU0306	3/16	.0938	11/32	1/2	—	1	16
S57PY5-SU0406		.1250					
S57PY5-SU0609	9/32	.1875	7/16	11/16		1-3/8	64
S57PY5-SU0812	3/8	.2500	1/2	7/8		1-3/4	256
*S57PY5-SU0812T							
Fig. 2 Double Joint							
S57PY5-DU0306	3/16	.0938	11/32	1/2	1/2	1-1/2	16
S57PY5-DU0406		.1250					
S57PY5-DU0609	9/32	.1875	7/16	11/16	5/8	2	64
S57PY5-DU0812	3/8	.2500	1/2	7/8	3/4	2-1/2	256
*S57PY5-DU0812T							

* 1-tapped hole, #6-32, 1/4" from each end. Two set screws installed.