

SHORT SERIES FLEXIBLE HELICAL COUPLINGS



SPLIT HUB TYPE
ZERO BACKLASH

PHONE: 516.328.3300 • FAX: 516.326.8827 • WWW.SDP-SI.COM



> MATERIAL:

Coupling - 17-4PH Stainless Steel, Heat-Treated to H900
Cap Screw - Alloy Steel

> MISALIGNMENT COMPENSATION:

Max. Angular Offset: 5°
Max. Lateral Offset: .010
Max. Axial Motion: ± .010

> FEATURES:

One-piece construction.
Integral clamp.
Shaft relief.
High fatigue resistance.
Constant velocity.



For NONREVERSING applications, the torque rating is 1/2.
For REVERSING applications, the torque rating is 1/4.

Bore diameter combinations are available on special order.

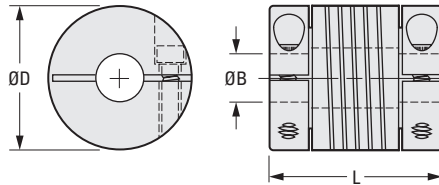

INCH COMPONENT

Catalog Number	D O.D.	B Bore +.002 -.000	L Length ± .01	Cap Screw Size	Momentary* Dynamic Torque lbf in.	Torsional Deflection Arc Min. / lbf in.	Inertia Δ x 10 ⁻⁵ lbf in. sec. ²
S50HWH-037H0303	3/8	.094	.56	#0-80	2.4	90	.070
S50HWH-050H0303	1/2	.094	.75	#1-72	7.5	21.6	.31
S50HWH-050H0404		.125			7	28.8	
S50HWH-062H0404	5/8	.125	.80	#2-56	14	11.4	.78
S50HWH-062H0505		.157			13	14.4	
S50HWH-062H0606		.188			12	18.6	
S50HWH-075H0404		.125			21	6.6	
S50HWH-075H0505	3/4	.157	.90	#4-40	20	7.8	1.8
S50HWH-075H0606		.188			20	9.6	
S50HWH-075H0808		.250			17	15	
S50HWH-087H0606	7/8	.188	1.06	#6-32	37	4.32	4.1
S50HWH-087H0808		.250			34	6	
S50HWH-087H1010		.313			30	9	
S50HWH-100H0808	1	.250	1.25	#6-32	52	3.72	8.3
S50HWH-100H1010		.313			47	5.16	
S50HWH-100H1212		.375			42	7.2	
S50HWH-112H0808	1-1/8	.250	1.50	#6-32	83	2.1	15.6
S50HWH-112H1010		.313			78	2.7	
S50HWH-112H1212		.375			71	3.66	
S50HWH-112H1616		.500			55	7.2	

* Torque listed is maximum momentary value.

Δ Inertia is based on the smallest standard bore diameter.

6-27
D820

REVISED:
05/17/23

- I
- R
- T
- 1
- 2
- 3
- 4
- 5
- 6
- 7
- 8
- 9
- 10
- 11
- 12
- 13
- 14
- 15
- 16