

FLANGE-MOUNTED BALL BEARINGS



SELF-ALIGNING TO $\pm 5^\circ$
 FLANGE-MOUNTED
 DOUBLE SHIELDS
 ABEC 3

PHONE: 516.328.3300 • FAX: 516.326.8827 • WWW.SDP-SI.COM



> MATERIAL:

Bearing - High Chromium Alloy Steel
Flange & Retainer - Carbon Steel, Black Oxide Finish

> OPERATING TEMPERATURE:

-30°F to +250°F

> SPECIFICATIONS:

Max. Speed: 40000 rpm

Max. Radial Load - Static: 61 lbf

Dynamic: 122 lbf

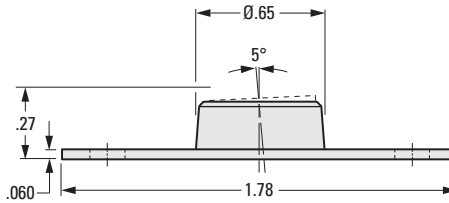
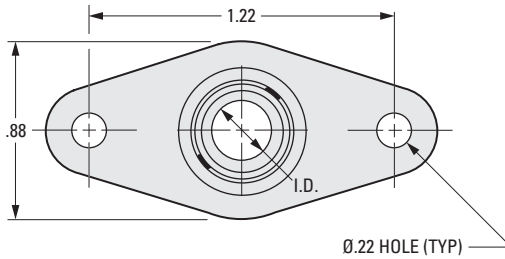

INCH COMPONENT

Catalog Number	Nom. I.D.
A 7Z58-BFM187L	3/16
A 7Z58-BFM250L	1/4
A 7Z58-BFM312L	5/16

- I
- R
- T
- 1
- 2
- 3
- 4
- NEW**
- 6
- 7
- 8
- 9
- 10
- 11
- 12
- 13
- 14
- 15
- 16

5-12B

REV:
2/27/23