

SELF-CLINCHING BALL BEARINGS



SELF-ALIGNING TO $\pm 5^\circ$
 DOUBLE SHIELDS
 ABEC 3

PHONE: 516.328.3300 • FAX: 516.326.8827 • WWW.SDP-SI.COM



> MATERIAL:

Bearing - High Chromium Alloy Steel
Retainer - Carbon Steel, Black Oxide Finish

> OPERATING TEMPERATURE:

-30°F to +250°F

> FEATURES:

High-speed applications.
 Knurling ensures secure self-clinching.
 Simple, quick installation.
 Major assembly and production savings.
 Mounting blocks not necessary.

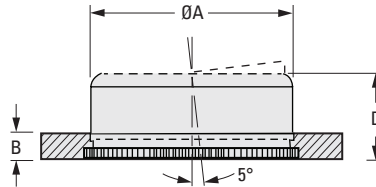
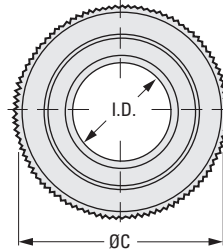

- I
- R
- T
- 1
- 2
- 3
- 4
- NEW**
- 6
- 7
- 8
- 9
- 10
- 11
- 12
- 13
- 14
- 15
- 16

INCH COMPONENT

Catalog Number	Nom. I.D.	A Panel Hole Dia. +.003 -.000	B Min. Panel Thickness	C Knurl O.D.	D Height	Max. Speed rpm	Max. Radial Load lbf	
							Static	Dynamic
A 7Z54-FSL187	3/16	.640	.060	.69	.281	40000	61	122
A 7Z54-FSL250	1/4							
A 7Z54-FSL312	5/16	.944	.074	1.00	.375	36000	188	385
A 7Z54-FSL375	3/8							

5-13
 D820

REV:
 3/15/23