

ABEC 5 AND 7
.0002 / .0005 RADIAL PLAY

PHONE: 516.328.3300 • FAX: 516.326.8827 • WWW.SDP-SI.COM

> MATERIAL:

440C Stainless Steel

> LOAD RATING

Bearing Code	Dynamic lbf	Static lbf
0415	16	5
0518	26	9.5
0725	35	13
0918	21	7.5
0931	62	24
1225	35	13
1231	63	24
1237	73	29
1238		
1531	41	17
1831		
1837	81	34
1850	149	65
2537	43	20
2550	123	54
2562	170	77
3150	62	31
3787	569	273

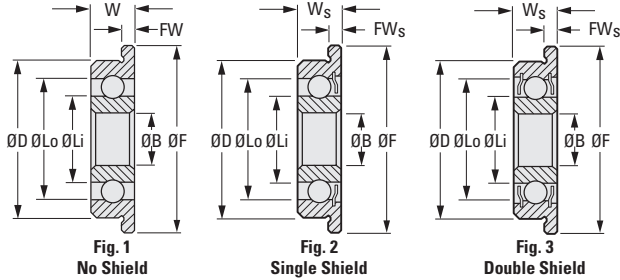
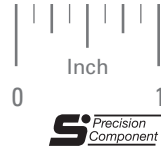
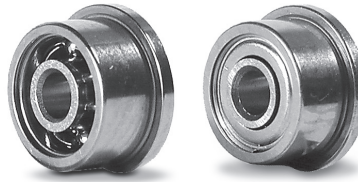

NOTE: Land Diameters Li Inner and Lo Outer are for reference only; these dimensions may vary from what is stated on the page. If this is a critical dimension - Call the Engineering Dept. for assistance.

INCH COMPONENT CATALOG NUMBER

S9912Y- **FS**
 ABEC 5 **E** — Bearing Code
 ABEC 7 **G** —
 Fig. 1, No Shield **0**
 Fig. 2, Single Shield **1**
 Fig. 3, Double Shield **2**

Lubrication

- Leave Blank for Oil, MIL-L-6085A
- M** Grease, MIL-G-23827A
- G** Grease, Beacon 325 Commercial
Other Lubricants available on special order.

Example:

S9912Y-G1837FS2 is an ABEC 7, Double-Shielded Oiled Bearing with 3/16 Bore and 3/8 O.D.

Bearing Code	B Bore +.0000 -0.0002	D Outer Ring Dia. +.0000 -0.0002	Width +.000 -0.001		Flange Width +.000 -0.002		F Flange Dia. +.000 -0.001	Land Dia. (Ref.)		
			W	Ws	FW	FWs		Li Inner		Lo Outer
								All	Fig.1	Fig. 2 & 3
0415	.0469	.1562	.0625	.0937	.013	.023	.203	.081	.124	.134
0518	.0550	.1875	.0781	.1094	.018		.234	.093	.159	.167
0725	.0781	.2500	.0937	.1406		.023	.296	.122	.193	.205
0918	.0937	.1875	.0625	.0937	.030		.234	.118	.161	.167
0931		.3125	.1094	.1406		.359	.173	.270	.282	
1225	.1250	.2500	.0937	.1094	.030	.296	.161	.216	.228	
1231		.3125	.1094	.1406		.023	.359	.173	.270	.282
1237	.3750	.1562			.1562		.030			
1238			.1562	.1094		.1250		.023	.440	.221
1531	.1875	.3750			.1250		.036		.359	
1831			.5000	.1562		.1960		.042	.422	.276
1837	.3750	.1250			.1250		.036		.565	
1850			.5000	.1250		.1875		.045	.422	.330
2537	.2500	.6250			.1960		.042		.547	
2550			.3125	.5000		.1562		.1562	.690	.362
2562	.3750	.8750			.2812		.2812		.547	
3150			.3750	.8750		.2812		.2812	.969	.521
3787										