

# TELESCOPING MINIATURE BALL SPLINES

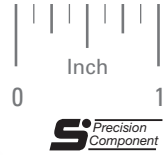

ZERO BACKLASH  
 LOW INERTIA  
 ACCOMMODATES 1/4" AXIAL MOTION

PHONE: 516.328.3300 • FAX: 516.326.8827 • WWW.SDP-SI.COM



**> MATERIAL:**

**Body & Shaft** - 440 Stainless Steel  
**Balls** - 440 Stainless Steel

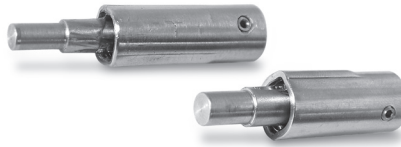

**> MAXIMUM OPERATING SPEED:**

8000 rpm

**> FEATURES:**

Zero Backlash is attained with patented design and close dimensional control of components.  
 Use where axial motion is present while transmitting rotary motion.  
 Will not accommodate angular misalignment.

**> LUBRICATION:**

Dry Film Plus Oil Suspension

These splines may be mated to S57PY5-... and S57PY4-... series of universal joints to make telescoping universal joints.

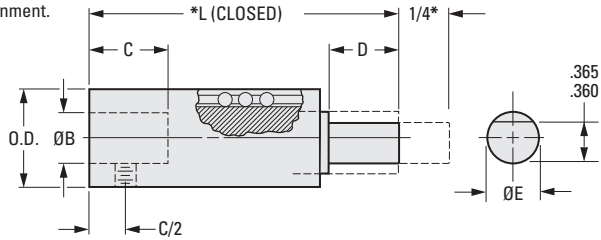

Fig. 1

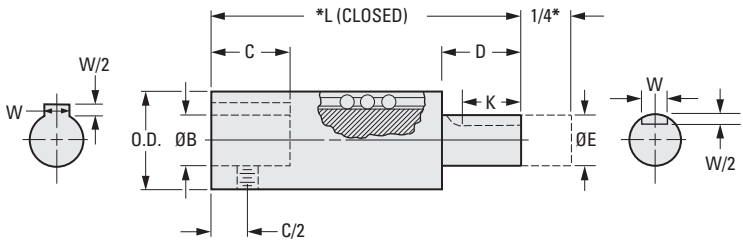

Fig. 2

**INCH COMPONENT**

Catalog Number	O.D.	B Bore +.001 -.000	C Bore Depth	D Shoulder Length	E Dia. +.000 -.001	L * Closed	Set Screw Size	Torque ozf in.	K Keyway Length (min.)	W Keyway Width +.0015 -.0000
<b>Fig. 1</b>										
S59PQ5-TBS1232	1	.375	1/2	1/2	.375	2-1/8	1/4-20	1200	—	—
<b>Fig. 2</b>										
S59PQ5-TBS2048	1-1/2	.625	3/4	3/4	.625	3	5/16-18	4800	1/2	.1875
S59PQ5-TBS3264	2	1.000	1-1/4	1-1/4	1.000	4-1/4	3/8-16	9600	3/4	.2500

\* Closed dimensions for standard 1/4" of travel (min.).  
 Up to 4" of travel available on special order.

See additional items on the previous page