

SIZE 18
.120 FACE

PHONE: 516.328.3300 • FAX: 516.326.8827 • WWW.SDP-SI.COM

> **MATERIAL:**

Ladder Chain - Galvanized Steel, Brass, High-Tensile
Stainless Steel or Stainless Steel

Sprocket - Brass

> **SPECIFICATIONS:**

Sprockets with:

6 teeth have a #4-40 set screw

8 to 20 teeth have a #8-32 set screw

24 to 48 teeth have a #10-32 set screw

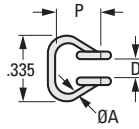

Fig. 1

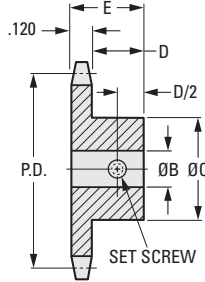

Fig. 2

INCH COMPONENT

Catalog Number	Material	P Pitch	Links Per Foot	A Wire Dia.	D Inside Width	Yield Point lbf
Fig. 1 Ladder Chains - Priced Per Foot						
A 6C 8-18	Steel, Galvanized	.286	42	.0475	.130	40
A 6C88-18	High-Tensile Stainless Steel, 400 Series					75
A 6B 8-18	Brass					25
A 6Y 8-18	Stainless Steel, 300 Series					40

Catalog Number	No. of Teeth	P.D.	B Bore	E Length	C Hub Dia.	D Hub Proj.
Fig. 2 Sprockets						
A 6B 8-1806	6	.57	3/16	3/8	3/8	1/4
A 6B 8-1808	8	.75			7/16	
A 6B 8-1809	9	.83			1/2	
A 6B 8-1810	10	.92				
A 6B 8-1811	11	1.02	1/4	7/16	5/8	5/16
A 6B 8-1812	12	1.10				
A 6B 8-1814	14	1.28				
A 6B 8-1816	16	1.47				
A 6B 8-1818	18	1.64	5/16	1/2	3/4	3/8
A 6B 8-1820	20	1.82				
A 6B 8-1824	24	2.18				
A 6B 8-1827	27	2.47				
A 6B 8-1832	32	2.92	3/8	1/2	3/4	3/8
A 6B 8-1844	44	4.00				
A 6B 8-1848	48	4.36				

I
R
T
1
2
3
4
5
6
7
8
9
10
11
12
13
14
15
16