

SIZE 19
.087 FACE

PHONE: 516.328.3300 • FAX: 516.326.8827 • WWW.SDP-SI.COM

> **MATERIAL:**

Ladder Chain - Galvanized Steel, Brass, High-Tensile
Stainless Steel or Stainless Steel

Sprocket - Brass

> **SPECIFICATIONS:**

Sprockets with:

- 6 to 8 teeth have a #4-40 set screw
- 9 & 10 teeth have a #6-32 set screw
- 12 to 32 teeth have a #8-32 set screw
- 36 to 72 teeth have a #10-32 set screw

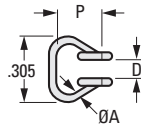
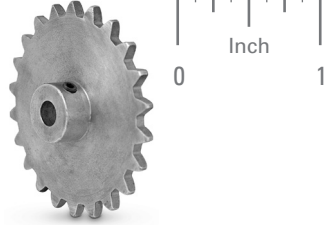

Fig. 1

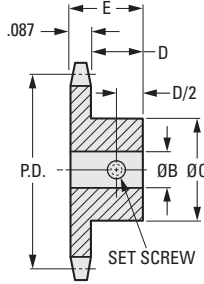

Fig. 2

INCH COMPONENT

Catalog Number	Material	P Pitch	Links Per Foot	A Wire Dia.	D Inside Width	Yield Point lbf
Fig. 1 Ladder Chains - Priced Per Foot						
A 6C 8-19	Steel, Galvanized	.185	65	.041	.120	30
A 6C88-19	High-Tensile Stainless Steel, 400 Series					55
A 6B 8-19	Brass					18
A 6Y 8-19	Stainless Steel, 300 Series					30

Catalog Number	No. of Teeth	P.D.	B Bore	E Length	C Hub Dia.	D Hub Proj.
Fig. 2 Sprockets						
A 6B 8-1906	6	.36	1/8	11/32	1/4	1/4
A 6B 8-1907	7	.41			5/16	
A 6B 8-1908	8	.47			3/8	
A 6B 8-1909	9	.53			7/16	
A 6B 8-1910	10	.59	3/16	13/32	1/2	5/16
A 6B 8-1912	12	.70				
A 6B 8-1915	15	.87				
A 6B 8-1916	16	.93				
A 6B 8-1918	18	1.06	1/4	13/32	5/8	5/16
A 6B 8-1920	20	1.16				
A 6B 8-1924	24	1.38				
A 6B 8-1932	32	1.86				
A 6B 8-1936	36	2.12	5/16	13/32	11/16	5/16
A 6B 8-1948	48	2.78				
A 6B 8-1960	60	3.48				
A 6B 8-1972	72	4.21				

I
R
T
1
2
3
4
5
6
7
8
9
10
11
12
13
14
15
16