

► **MATERIAL:**

Aluminum Alloy or Steel

PHONE: 516.328.3300 • FAX: 516.326.8827 • WWW.SDP-SI.COM

► **SPECIFICATIONS:**

O.D. Tolerance:

From 10 to 17 grooves is +.003/- .000 (+0.08)

From 18 to 32 grooves is +.004/- .000 (+0.10)

From 34 to 48 grooves is +.005/- .000 (+0.13)

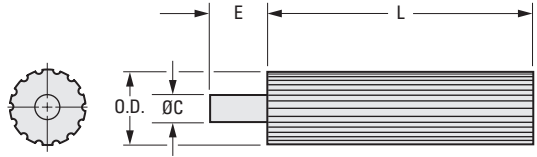

**INCH COMPONENT**

Catalog Number		No. of Grooves	Inch		Metric		C Shank Dia.	E Shank Length	L Min. Usable Length
Aluminum	Steel		P.D.	O.D.	P.D.	O.D.			
A 6A 4-10L08	A 6C 4-10L08	10	1.194	1.164	30.3	29.56	3/4 (19.1)	1-1/8 (28.6)	8 (203.2)
A 6A 4-11L08	A 6C 4-11L08	11	1.313	1.283	33.4	32.59	3/4 (19.1)	1-1/8 (28.6)	8 (203.2)
A 6A 4-12L08	A 6C 4-12L08	12	1.432	1.402	36.4	35.62	1 (25.4)	1-1/8 (28.6)	8 (203.2)
A 6A 4-12L12	A 6C 4-12L12	12	1.432	1.402	36.4	35.62	1 (25.4)	1-1/8 (28.6)	12 (304.8)
A 6A 4-13L08	A 6C 4-13L08	13	1.552	1.522	39.4	38.65	1 (25.4)	1-1/8 (28.6)	8 (203.2)
A 6A 4-14L08	A 6C 4-14L08	14	1.671	1.641	42.4	41.68	1 (25.4)	1-1/8 (28.6)	8 (203.2)
A 6A 4-14L12	A 6C 4-14L12	14	1.671	1.641	42.4	41.68	1 (25.4)	1-1/8 (28.6)	12 (304.8)
A 6A 4-15L08	A 6C 4-15L08	15	1.790	1.760	45.5	44.72	1 (25.4)		8 (203.2)
A 6A 4-15L12	A 6C 4-15L12	15	1.790	1.760	45.5	44.72	1 (25.4)		12 (304.8)
A 6A 4-16L08	A 6C 4-16L08	16	1.910	1.880	48.5	47.75	1 (25.4)		8 (203.2)
A 6A 4-16L12	A 6C 4-16L12	16	1.910	1.880	48.5	47.75	1 (25.4)		12 (304.8)
A 6A 4-17L08	A 6C 4-17L08	17	2.029	1.999	51.5	50.78	1 (25.4)		8 (203.2)
A 6A 4-18L08	A 6C 4-18L08	18	2.149	2.119	54.6	53.81	1 (25.4)		8 (203.2)
A 6A 4-18L12	—	18	2.149	2.119	54.6	53.81	1 (25.4)		12 (304.8)
A 6A 4-19L08	A 6C 4-19L08	19	2.268	2.238	57.6	56.84	1 (25.4)		8 (203.2)
A 6A 4-20L08	A 6C 4-20L08	20	2.387	2.357	60.6	59.88	1 (25.4)		8 (203.2)
A 6A 4-20L12	A 6C 4-20L12	20	2.387	2.357	60.6	59.88	1 (25.4)		12 (304.8)
A 6A 4-21L08	A 6C 4-21L08	21	2.507	2.477	63.7	62.91	1 (25.4)		8 (203.2)
A 6A 4-21L12	A 6C 4-21L12	21	2.507	2.477	63.7	62.91	1 (25.4)		12 (304.8)
—	A 6C 4-22L08	22	2.626	2.596	66.7	65.94	1 (25.4)		8 (203.2)
A 6A 4-22L12	A 6C 4-22L12	22	2.626	2.596	66.7	65.94	1 (25.4)		12 (304.8)
A 6A 4-23L10	—	23	2.745	2.715	69.7	68.97	1 (25.4)		10 (254)
A 6A 4-24L08	A 6C 4-24L08	24	2.865	2.835	72.8	72	1 (25.4)		8 (203.2)
A 6A 4-24L12	A 6C 4-24L12	24	2.865	2.835	72.8	72	1 (25.4)		12 (304.8)
A 6A 4-26L08	A 6C 4-26L08	26	3.104	3.074	78.8	78.07	1 (25.4)		8 (203.2)
A 6A 4-28L08	A 6C 4-28L08	28	3.342	3.312	84.9	84.13	1 (25.4)		8 (203.2)
A 6A 4-28L12	—	28	3.342	3.312	84.9	84.13	1 (25.4)		12 (304.8)
A 6A 4-29L10	—	29	3.462	3.432	87.9	87.16	1 (25.4)		10 (254)
A 6A 4-30L08	A 6C 4-30L08	30	3.581	3.551	91	90.2	1 (25.4)		8 (203.2)
A 6A 4-30L12	A 6C 4-30L12	30	3.581	3.551	91	90.2	1 (25.4)		12 (304.8)
A 6A 4-32L08	A 6C 4-32L08	32	3.820	3.790	97	96.26	1 (25.4)		8 (203.2)
A 6A 4-32L12	A 6C 4-32L12	32	3.820	3.790	97	96.26	1 (25.4)		12 (304.8)
A 6A 4-34L10	—	34	4.058	4.028	103.1	102.32	1 (25.4)	1 (25.4)	10 (254)
A 6A 4-36L08	—	36	4.297	4.267	109.1	108.39	1 (25.4)	1 (25.4)	8 (203.2)
A 6A 4-36L12	A 6C 4-36L12	36	4.297	4.267	109.1	108.39	1 (25.4)	1 (25.4)	12 (304.8)
A 6A 4-40L10	—	40	4.775	4.745	121.3	120.51	1 (25.4)	1 (25.4)	10 (254)
A 6A 4-42L10	—	42	5.013	4.983	127.3	126.58	1 (25.4)	1 (25.4)	10 (254)
A 6A 4-44L10	—	44	5.252	5.222	133.4	132.64	1 (25.4)	1 (25.4)	10 (254)
A 6A 4-48L10	—	48	5.730	5.700	145.5	144.77	1 (25.4)	1 (25.4)	10 (254)

NOTE: Dimensions in ( ) are mm.

Δ Dimensions in [ ] may be substituted at SDP option.

Continued from the previous page