

FOR 3/8" BELTS
 MOLDED WITH INSERT
 SINGLE FLANGE

PHONE: 516.328.3300 • FAX: 516.326.8827 • WWW.SDP-SI.COM

➤ MATERIAL:

Pulley - Polycarbonate, Fiberglass Reinforced
Insert - Aluminum, Knurled

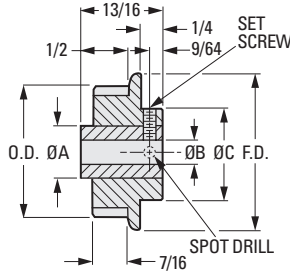
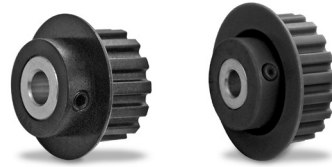

Fig. 1

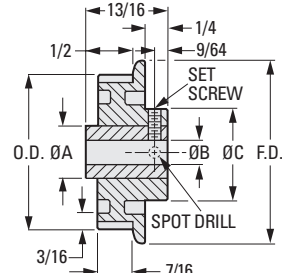

Fig. 2

INCH COMPONENT

| Catalog Number | No. of Grooves | P.D. | O.D. | F.D. | B Bore +.001 -.000 | A Dia. | C Hub Dia. | Set Screw |
|------------------|----------------|-------|-------|------|--------------------------|--------|------------|-----------|
| Fig. 1 | | | | | | | | |
| A 6Z 3-10SF03706 | 10 | .637 | .617 | .87 | .1875 | 3/8 | 11/16 | #6-32 |
| A 6Z 3-10SF03708 | 10 | .637 | .617 | .87 | .250 | 3/8 | 11/16 | #6-32 |
| A 6Z 3-11SF03706 | 11 | .700 | .680 | .93 | .1875 | 3/8 | 11/16 | #6-32 |
| A 6Z 3-11SF03708 | 11 | .700 | .680 | .93 | .250 | 3/8 | 11/16 | #6-32 |
| A 6Z 3-12SF03706 | 12 | .764 | .744 | .99 | .1875 | 3/8 | 11/16 | #6-32 |
| A 6Z 3-12SF03708 | 12 | .764 | .744 | .99 | .250 | 3/8 | 11/16 | #6-32 |
| A 6Z 3-13SF03706 | 13 | .828 | .808 | 1.06 | .1875 | 3/8 | 11/16 | #6-32 |
| A 6Z 3-13SF03708 | 13 | .828 | .808 | 1.06 | .250 | 3/8 | 11/16 | #6-32 |
| A 6Z 3-14SF03708 | 14 | .891 | .871 | 1.12 | .250 | 1/2 | 3/4 | #8-32 |
| A 6Z 3-14SF03710 | 14 | .891 | .871 | 1.12 | .3125 | 1/2 | 3/4 | #8-32 |
| A 6Z 3-14SF03712 | 14 | .891 | .871 | 1.12 | .375 | 1/2 | 3/4 | #8-32 |
| A 6Z 3-15SF03708 | 15 | .955 | .935 | 1.19 | .250 | 1/2 | 3/4 | #8-32 |
| A 6Z 3-15SF03710 | 15 | .955 | .935 | 1.19 | .3125 | 1/2 | 3/4 | #8-32 |
| A 6Z 3-15SF03712 | 15 | .955 | .935 | 1.19 | .375 | 1/2 | 3/4 | #8-32 |
| A 6Z 3-16SF03708 | 16 | 1.019 | .999 | 1.24 | .250 | 1/2 | 3/4 | #8-32 |
| A 6Z 3-16SF03710 | 16 | 1.019 | .999 | 1.24 | .3125 | 1/2 | 3/4 | #8-32 |
| A 6Z 3-16SF03712 | 16 | 1.019 | .999 | 1.24 | .375 | 1/2 | 3/4 | #8-32 |
| A 6Z 3-17SF03708 | 17 | 1.082 | 1.063 | 1.31 | .250 | 1/2 | 3/4 | #8-32 |
| A 6Z 3-17SF03710 | 17 | 1.082 | 1.063 | 1.31 | .3125 | 1/2 | 3/4 | #8-32 |
| A 6Z 3-17SF03712 | 17 | 1.082 | 1.063 | 1.31 | .375 | 1/2 | 3/4 | #8-32 |
| A 6Z 3-18SF03708 | 18 | 1.146 | 1.126 | 1.38 | .250 | 1/2 | 3/4 | #8-32 |
| A 6Z 3-18SF03710 | 18 | 1.146 | 1.126 | 1.38 | .3125 | 1/2 | 3/4 | #8-32 |
| A 6Z 3-18SF03712 | 18 | 1.146 | 1.126 | 1.38 | .375 | 1/2 | 3/4 | #8-32 |
| Fig. 2 | | | | | | | | |
| A 6Z 3-19SF03708 | 19 | 1.210 | 1.190 | 1.44 | .250 | 1/2 | 3/4 | #8-32 |
| A 6Z 3-19SF03710 | 19 | 1.210 | 1.190 | 1.44 | .3125 | 1/2 | 3/4 | #8-32 |
| A 6Z 3-19SF03712 | 19 | 1.210 | 1.190 | 1.44 | .375 | 1/2 | 3/4 | #8-32 |
| A 6Z 3-20SF03708 | 20 | 1.273 | 1.253 | 1.51 | .250 | 1/2 | 7/8 | #8-32 |
| A 6Z 3-20SF03710 | 20 | 1.273 | 1.253 | 1.51 | .3125 | 1/2 | 7/8 | #8-32 |
| A 6Z 3-20SF03712 | 20 | 1.273 | 1.253 | 1.51 | .375 | 1/2 | 7/8 | #8-32 |

Continued on the next page