

XL TIMING BELT PULLEYS • 1/5" PITCH



FOR BELTS UP TO 3/8" WIDE

PHONE: 516.328.3300 • FAX: 516.326.8827 • WWW.SDP-SI.COM

HUBLESS
DOUBLE FLANGE

> MATERIAL:

Aluminum Alloy

> FINISH:

Clear Anodized

> SPECIFICATIONS:

O.D. Tolerance: 10 to 16 grooves is +.002/- .000
 18 to 30 grooves is +.003/- .000
 32 grooves is +.004/- .000

* Pulleys with 10, 11 & 12 grooves have 1 set screw;
 others have 2 set screws at approximately 90°.

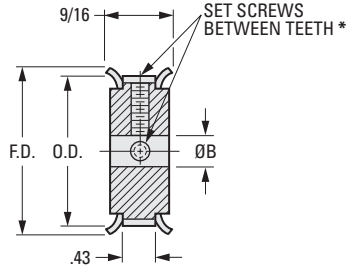
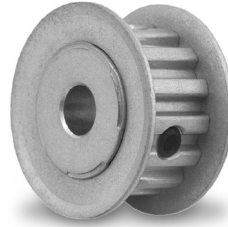

INCH COMPONENT

Catalog Number	No. of Grooves	P.D.	O.D.	F.D.	B Bore +.001 -.000	Set Screw
A 6A 3-10H3706	10	.637	.617	7/8	.1875	#6-32
A 6A 3-10H3708	10	.637	.617	7/8	.250	#6-32
A 6A 3-11H3706	11	.701	.680	15/16	.1875	#6-32
A 6A 3-11H3708	11	.701	.680	15/16	.250	#6-32
A 6A 3-12H3706	12	.764	.744	1	.1875	#6-32
A 6A 3-12H3708	12	.764	.744	1	.250	#8-32
A 6A 3-14H3708	14	.891	.871	1-3/32	.250	#8-32
A 6A 3-14H3710	14	.891	.871	1-3/32	.3125	#8-32
A 6A 3-14H3712	14	.891	.871	1-3/32	.375	#8-32
A 6A 3-15H3708	15	.955	.935	1-3/16	.250	#8-32
A 6A 3-15H3710	15	.955	.935	1-3/16	.3125	#8-32
A 6A 3-16H3708	16	1.019	.999	1-1/4	.250	#8-32
A 6A 3-16H3710	16	1.019	.999	1-1/4	.3125	#8-32
A 6A 3-18H3708	18	1.146	1.126	1-3/8	.250	#8-32
A 6A 3-18H3710	18	1.146	1.126	1-3/8	.3125	#8-32
A 6A 3-18H3716	18	1.146	1.126	1-3/8	.500	#8-32
A 6A 3-20H3708	20	1.273	1.253	1-1/2	.250	#8-32
A 6A 3-20H3710	20	1.273	1.253	1-1/2	.3125	#8-32
A 6A 3-20H3712	20	1.273	1.253	1-1/2	.375	#8-32
A 6A 3-21H3708	21	1.337	1.317	1-9/16	.250	#8-32
A 6A 3-21H3710	21	1.337	1.317	1-9/16	.3125	#8-32
A 6A 3-22H3708	22	1.401	1.381	1-5/8	.250	#8-32
A 6A 3-22H3710	22	1.401	1.381	1-5/8	.3125	#8-32
A 6A 3-24H3708	24	1.528	1.508	1-3/4	.250	#8-32
A 6A 3-24H3710	24	1.528	1.508	1-3/4	.3125	#8-32
A 6A 3-24H3712	24	1.528	1.508	1-3/4	.375	#8-32
A 6A 3-28H3708	28	1.783	1.763	2	.250	#8-32
A 6A 3-28H3712	28	1.783	1.763	2	.375	#8-32
A 6A 3-30H3708	30	1.910	1.890	2-1/8	.250	#8-32
A 6A 3-30H3712	30	1.910	1.890	2-1/8	.375	#8-32
A 6A 3-32H3710	32	2.037	2.017	2-1/4	.3125	#8-32
A 6A 3-32H3712	32	2.037	2.017	2-1/4	.375	#8-32

