

► MATERIAL:

Carbon Steel

PHONE: 516.328.3300 • FAX: 516.326.8827 • WWW.SDP-SI.COM

► SPECIFICATIONS:

O.D. Tolerance:

10 to 16 grooves is +.002/- .000 (+0.05/0)

17 to 30 grooves is +.003/- .000 (+0.08/0)

32 to 72 grooves is +.004/- .000 (+0.10/0)

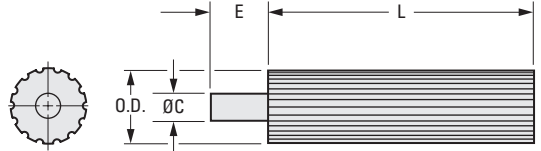

INCH COMPONENT

Catalog Number	No. of Grooves	Inch		Metric		C Shank Dia.	E Shank Length	L Min. Usable Length
		P.D.	O.D.	P.D.	O.D.			
A 6C 2-10XL06	10	.637	.617	16.2	15.67	1/2 (12.7) [7/16 (11.1)] ^Δ	7/8 (22.3)	6 (152.4)
A 6C 2-11XL06	11	.700	.680	17.8	17.27	1/2 (12.7)	7/8 (22.3)	6 (152.4)
A 6C 2-12XL08	12	.764	.744	19.4	18.9	1/2 (12.7)		8 (203.2)
A 6C 2-13XL08	13	.828	.808	21	20.52	1/2 (12.7)		8 (203.2)
A 6C 2-14XL08	14	.891	.871	22.6	22.12	1/2 (12.7)		8 (203.2)
A 6C 2-15XL08	15	.955	.935	24.3	23.75	1/2 (12.7)		8 (203.2)
A 6C 2-16XL08	16	1.019	.999	25.9	25.37	1/2 (12.7)		8 (203.2)
A 6C 2-17XL08	17	1.082	1.062	27.5	26.98	1/2 (12.7)		8 (203.2)
A 6C 2-18XL08	18	1.146	1.126	29.1	28.6	1/2 (12.7)		8 (203.2)
A 6C 2-19XL08	19	1.210	1.190	30.7	30.23	1/2 (12.7)		8 (203.2)
A 6C 2-20XL08	20	1.273	1.253	32.3	31.83	1/2 (12.7)		8 (203.2)
A 6C 2-21XL08	21	1.337	1.317	34	33.45	1/2 (12.7)		8 (203.2)
A 6C 2-22XL08	22	1.401	1.381	35.6	35.08	1/2 (12.7)	1 (25.4)	8 (203.2)
A 6C 2-23XL08	23	1.464	1.444	37.2	36.68	1/2 (12.7)	[3/4 (19.1)] ^Δ	8 (203.2)
A 6C 2-24XL08	24	1.528	1.508	38.8	38.3	1/2 (12.7)		8 (203.2)
A 6C 2-25XL08	25	1.592	1.572	40.4	39.93	1/2 (12.7)		8 (203.2)
A 6C 2-26XL08	26	1.655	1.635	42	41.53	1/2 (12.7)		8 (203.2)
A 6C 2-27XL08	27	1.719	1.699	43.7	43.15	1/2 (12.7)		8 (203.2)
A 6C 2-28XL08	28	1.783	1.763	45.3	44.78	1/2 (12.7)		8 (203.2)
A 6C 2-29XL08	29	1.846	1.826	46.9	46.38	1/2 (12.7)		8 (203.2)
A 6C 2-30XL08	30	1.910	1.890	48.5	49.01	1/2 (12.7)		8 (203.2)
A 6C 2-32XL08	32	2.037	2.017	51.7	51.23	1/2 (12.7)	1 (25.4)	8 (203.2)
A 6C 2-33XL08	33	2.101	2.081	53.4	52.86	1/2 (12.7)	1 (25.4)	8 (203.2)
A 6C 2-34XL08	34	2.165	2.145	55	54.48	1/2 (12.7)	1 (25.4)	8 (203.2)
A 6C 2-35XL08	35	2.228	2.208	56.6	56.08		1 (25.4)	8 (203.2)
A 6C 2-36XL08	36	2.292	2.272	58.2	57.71		1 (25.4)	8 (203.2)
A 6C 2-38XL08	38	2.419	2.399	61.4	60.93		1 (25.4)	8 (203.2)
A 6C 2-40XL08	40	2.546	2.526	64.7	64.16		1 (25.4)	8 (203.2)
A 6C 2-42XL08	42	2.674	2.654	67.9	67.41	1 (25.4)	1 (25.4)	8 (203.2)
A 6C 2-44XL08	44	2.801	2.781	71.1	70.64		1 (25.4)	8 (203.2)
A 6C 2-45XL08	45	2.865	2.845	72.8	72.26		1 (25.4)	8 (203.2)
A 6C 2-46XL08	46	2.928	2.908	74.4	73.86	[3/4 (19.1)] ^Δ	1 (25.4)	8 (203.2)
A 6C 2-48XL08	48	3.056	3.036	77.6	77.11		1 (25.4)	8 (203.2)
A 6C 2-50XL08	50	3.183	3.163	80.9	80.34		1 (25.4)	8 (203.2)
A 6C 2-60XL08	60	3.820	3.800	97	96.52		1 (25.4)	8 (203.2)
A 6C 2-72XL08	72	4.584	4.564	116.4	115.93	1 (25.4)	1 (25.4)	8 (203.2)

NOTE: Dimensions in () are mm.

^Δ Dimensions in [] may be substituted at SDP option.

Continued from the previous page