

**FOR 3/16" BELTS**  
NO FLANGE

PHONE: 516.328.3300 • FAX: 516.326.8827 • WWW.SDP-SI.COM



**> MATERIAL:**  
Aluminum Alloy

**> FINISH:**  
Clear Anodized

**> SPECIFICATION:**  
All pulleys have 2 set screws at 90°

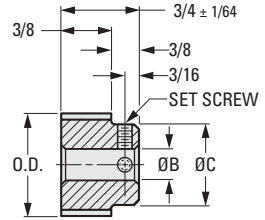

**INCH COMPONENT**

Catalog Number	No. of Grooves	P.D.	O.D. +0.001 -0.003	B Bore +0.001 -0.000	C Hub Dia. ± 1/64	Set Screw
A 6A 6-20NF01806	20	.520	.506	.1875	.436	#6-40
A 6A 6-20NF01808	20	.520	.506	.250	.436	#6-40
A 6A 6-24NF01806	24	.624	.610	.1875	.500	#6-40
A 6A 6-24NF01808	24	.624	.610	.250	.500	#8-32
A 6A 6-30NF01808	30	.780	.766	.250	.656	#8-32
A 6A 6-40NF01808	40	1.040	1.026	.250	.666	#8-32
A 6A 6-45NF01808	45	1.170	1.156	.250	.796	#8-32
A 6A 6-50NF01808	50	1.300	1.286	.250	.926	#8-32
A 6A 6-50NF01810	50	1.300	1.286	.3125	.926	#8-32
A 6A 6-60NF01808	60	1.560	1.546	.250	1.186	#8-32
A 6A 6-60NF01810	60	1.560	1.546	.3125	1.186	#8-32
A 6A 6-70NF01808	70	1.820	1.806	.250	1.150	#10-32
A 6A 6-70NF01812	70	1.820	1.806	.375	1.150	#10-32
A 6A 6-72NF01808	72	1.872	1.858	.250	1.202	#8-32
A 6A 6-72NF01812	72	1.872	1.858	.375	1.202	#10-32
A 6A 6-75NF01808	75	1.950	1.936	.250	1.266	#8-32
A 6A 6-75NF01812	75	1.950	1.936	.375	1.266	#10-32
A 6A 6-80NF01808	80	2.080	2.066	.250	1.396	#8-32
A 6A 6-80NF01812	80	2.080	2.066	.375	1.396	#10-32
A 6A 6-84NF01808	84	2.184	2.170	.250	1.500	#8-32
A 6A 6-84NF01812	84	2.184	2.170	.375	1.500	#10-32
A 6A 6-88NF01808	88	2.288	2.274	.250	1.500	#8-32
A 6A 6-88NF01812	88	2.288	2.274	.375	1.500	#10-32
A 6A 6-90NF01808	90	2.340	2.326	.250	1.500	#8-32
A 6A 6-90NF01812	90	2.340	2.326	.375	1.500	#10-32
A 6A 6-96NF01808	96	2.496	2.482	.250	1.500	#8-32
A 6A 6-96NF01812	96	2.496	2.482	.375	1.500	#10-32
A 6A 6-98NF01808	98	2.548	2.534	.250	1.500	#8-32
A 6A 6-98NF01812	98	2.548	2.534	.375	1.500	#10-32
A 6A61-00NF01810	100	2.600	2.586	.3125	1.500	#8-32
A 6A61-00NF01812	100	2.600	2.586	.375	1.500	#10-32
A 6A61-08NF01810	108	2.808	2.794	.3125	1.500	#8-32
A 6A61-08NF01812	108	2.808	2.794	.375	1.500	#10-32
A 6A61-20NF01810	120	3.120	3.106	.3125	1.500	#8-32
A 6A61-20NF01812	120	3.120	3.106	.375	1.500	#10-32