

RIGHT-HAND
DOUBLE THREAD
20° PRESSURE ANGLE

PHONE: 516.328.3300 • FAX: 516.326.8827 • WWW.SDP-SI.COM



> MATERIAL:

Worm Gears - Bronze
Worms - Steel

> SPECIFICATIONS, WORMS:

Lead: .1963
Lead Angle: 8° 8'

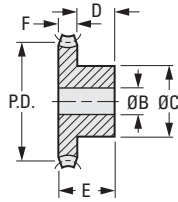

Worm Gear

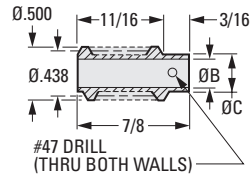

Worm

INCH COMPONENT

Catalog Number	No. of Teeth	P.D.	B Bore +.0010 -.0000	F Face Width	E Length	C Hub Dia.	D Hub Proj.									
Worm Gears - Bronze																
A 1B 6-Y32020A	20	.625	.1869	7/32	15/32	1/2	1/4									
A 1B 6-Y32030	30	.938		3/16	7/16	5/8										
A 1B 6-Y32030A	40	1.250		7/32	15/32		5/16									
A 1B 6-Y32040A	48	1.500	.1869	3/16	1/2	1/2	1/4									
A 1B 6-Y32048	50	1.562	.2494			3/16	1/2	5/8	5/16							
A 1B 6-Y32050	60	1.875						.2494		3/16	1/2	11/16				
A 1B 6-Y32060	72	2.250	.3119						3/16			1/2	5/8	5/16		
A 1B 6-Y32072	80	2.500						.3119					3/16		1/2	11/16
A 1B 6-Y32080	100	3.125	.3119											3/16		1/2
A 1B 6-Y32100																

Catalog Number	B Bore	B Tolerance	C Hub Dia.	Finish
Worms - Steel				
A 1C 5-Y32	.1875	+.0008/- .0000	.320	Soft
A 1Q 5-Y32	.2187	+.0010/- .0000	.320	Hardened & Polished
A 1Q55-5Y32		+.0008/- .0000	.340	Hardened & Ground

