

AGMA 10
1/4 BORE
PRECISION MATCHED SETS
20° PRESSURE ANGLE

PHONE: 516.328.3300 • FAX: 516.326.8827 • WWW.SDP-SI.COM

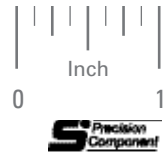

> MATERIAL:

303 Stainless Steel
2024-T4 or -T351 Aluminum Alloy,
anodized before cutting.

Available on special order:
Different bore size and/or material,
passivation for Stainless Steel.

Sold as Set

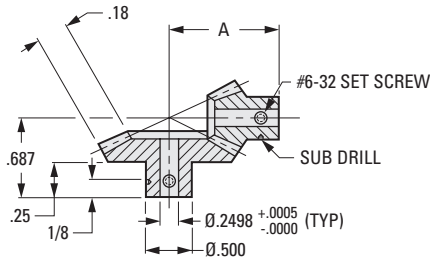
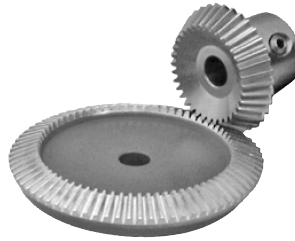

INCH COMPONENT

Catalog Number	Ratio	No. of Teeth	P.D.	A	Material
S1346Z-48S30A030	1:1	30	.625	.687	Stainless Steel Aluminum
S1346Z-48S30S030	1:1	30	.625	.687	Stainless Steel
S1346Z-48A30A030	1:1	30	.625	.687	Aluminum
S1346Z-48S30A045	1:1-1/2	30 45	.625 .937	.812	Stainless Steel Aluminum
S1346Z-48S30S045	1:1-1/2	30 45	.625 .937	.812	Stainless Steel
S1346Z-48A30A045	1:1-1/2	30 45	.625 .937	.812	Aluminum
S1346Z-48S30A060	1:2	30 60	.625 1.250	.937	Stainless Steel Aluminum
S1346Z-48S30S060	1:2	30 60	.625 1.250	.937	Stainless Steel
S1346Z-48A30A060	1:2	30 60	.625 1.250	.937	Aluminum
S1346Z-48S30A090	1:3	30 90	.625 1.875	1.250	Stainless Steel Aluminum
S1346Z-48S30S090	1:3	30 90	.625 1.875	1.250	Stainless Steel
S1346Z-48A30A090	1:3	30 90	.625 1.875	1.250	Aluminum
S1346Z-48S30A120	1:4	30 120	.625 2.500	1.531	Stainless Steel Aluminum
S1346Z-48S30S120	1:4	30 120	.625 2.500	1.531	Stainless Steel
S1346Z-48A30A120	1:4	30 120	.625 2.500	1.531	Aluminum