

INTERNAL GEARS • 32 & 24 PITCH



AGMA 10
1/8 FACE
20° PRESSURE ANGLE

PHONE: 516.328.3300 • FAX: 516.326.8827 • WWW.SDP-SI.COM

> MATERIAL:

303 Stainless Steel
2024-T4 Aluminum, Chromic Anodized Before Cutting

Available on special order:
14-1/2° P.A., teeth not listed,
different material, passivation
for Stainless Steel.

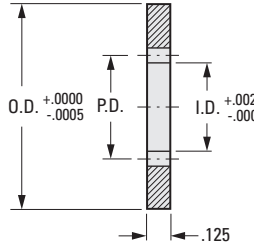
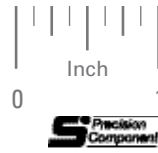
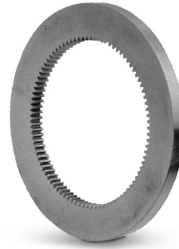

INCH COMPONENT

Catalog Number		No. of Teeth	P.D.	I.D.	O.D.
Stainless Steel	Aluminum				
32 Pitch					
S1E62Z-032S025	S1E62Z-032A025	25	.7813	.718	1.998
S1E62Z-032S030	S1E62Z-032A030	30	.9375	.875	
S1E62Z-032S035	S1E62Z-032A035	35	1.0938	1.031	
S1E62Z-032S040	S1E62Z-032A040	40	1.2500	1.187	
S1E62Z-032S045	S1E62Z-032A045	45	1.4063	1.343	
S1E63Z-032S045	S1E63Z-032A045	45	1.4063	1.343	2.998
S1E63Z-032S050	S1E63Z-032A050	50	1.5625	1.500	
S1E63Z-032S060	S1E63Z-032A060	60	1.8750	1.812	
S1E63Z-032S070	S1E63Z-032A070	70	2.1875	2.125	
S1E63Z-032S080	S1E63Z-032A080	80	2.5000	2.437	
S1E64Z-032S080	S1E64Z-032A080	80	2.5000	2.437	3.998
S1E64Z-032S085	S1E64Z-032A085	85	2.6563	2.593	
S1E64Z-032S090	S1E64Z-032A090	90	2.8125	2.750	
S1E64Z-032S096	S1E64Z-032A096	96	3.0000	2.937	
S1E64Z-032S100	S1E64Z-032A100	100	3.1250	3.062	
24 Pitch					
S1E62Z-024S020	S1E62Z-024A020	20	.8333	.750	1.998
S1E62Z-024S025	S1E62Z-024A025	25	1.0417	.958	
S1E62Z-024S030	S1E62Z-024A030	30	1.2500	1.166	
S1E62Z-024S035	S1E62Z-024A035	35	1.4583	1.375	
S1E63Z-024S035	S1E63Z-024A035	35	1.4583	1.375	
S1E63Z-024S040	S1E63Z-024A040	40	1.6667	1.583	2.998
S1E63Z-024S045	S1E63Z-024A045	45	1.8750	1.791	
S1E63Z-024S050	S1E63Z-024A050	50	2.0833	2.000	
S1E63Z-024S060	S1E63Z-024A060	60	2.5000	2.416	
S1E64Z-024S060	S1E64Z-024A060	60	2.5000	2.416	
S1E64Z-024S065	S1E64Z-024A065	65	2.7083	2.625	3.998
S1E64Z-024S070	S1E64Z-024A070	70	2.9167	2.834	
S1E64Z-024S072	S1E64Z-024A072	72	3.0000	2.916	
S1E64Z-024S078	S1E64Z-024A078	78	3.2500	3.166	

1-188
D820

REVISED:
6/26/23

1

R

T

1

2

3

4

5

6

7

8

9

10

11

12

13

14

15

16