

INTERNAL GEARS • 64 & 48 PITCH



AGMA 10
1/8 FACE
20° PRESSURE ANGLE

PHONE: 516.328.3300 • FAX: 516.326.8827 • WWW.SDP-SI.COM

> MATERIAL:

303 Stainless Steel
2024-T4 Aluminum, Chromic anodized before cutting.

Available on special order:
14-1/2° P.A., teeth not listed,
different material, passivation
for Stainless Steel.

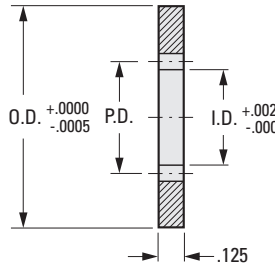
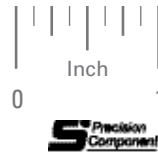
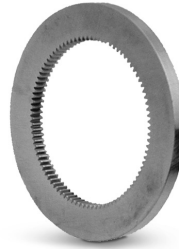

INCH COMPONENT					
Catalog Number		No. of Teeth	P.D.	I.D.	O.D.
Stainless Steel	Aluminum				
64 Pitch					
S1E62Z-064S050	S1E62Z-064A050	50	.7813	.750	1.998
S1E62Z-064S060	S1E62Z-064A060	60	.9375	.906	
S1E62Z-064S070	S1E62Z-064A070	70	1.0938	1.062	
S1E62Z-064S080	S1E62Z-064A080	80	1.2500	1.219	
S1E62Z-064S090	S1E62Z-064A090	90	1.4063	1.375	
S1E63Z-064S090	S1E63Z-064A090	90	1.4063	1.375	2.998
S1E63Z-064S100	S1E63Z-064A100	100	1.5625	1.531	
S1E63Z-064S120	S1E63Z-064A120	120	1.8750	1.843	
S1E63Z-064S140	S1E63Z-064A140	140	2.1875	2.156	
S1E63Z-064S160	S1E63Z-064A160	160	2.5000	2.468	3.998
S1E64Z-064S160	S1E64Z-064A160	160	2.5000	2.468	
S1E64Z-064S170	S1E64Z-064A170	170	2.6563	2.625	
S1E64Z-064S180	S1E64Z-064A180	180	2.8125	2.781	
S1E64Z-064S192	S1E64Z-064A192	192	3.0000	2.968	
S1E64Z-064S200	S1E64Z-064A200	200	3.1250	3.093	
48 Pitch					
S1E62Z-048S040	S1E62Z-048A040	40	.8333	.791	1.998
S1E62Z-048S050	S1E62Z-048A050	50	1.0417	1.000	
S1E62Z-048S060	S1E62Z-048A060	60	1.2500	1.208	
S1E62Z-048S070	S1E62Z-048A070	70	1.4583	1.416	
S1E63Z-048S070	S1E63Z-048A070	70	1.4583	1.416	2.998
S1E63Z-048S080	S1E63Z-048A080	80	1.6667	1.625	
S1E63Z-048S090	S1E63Z-048A090	90	1.8750	1.833	
S1E63Z-048S100	S1E63Z-048A100	100	2.0833	2.041	
S1E63Z-048S120	S1E63Z-048A120	120	2.5000	2.458	
S1E64Z-048S120	S1E64Z-048A120	120	2.5000	2.458	3.998
S1E64Z-048S130	S1E64Z-048A130	130	2.7083	2.666	
S1E64Z-048S140	S1E64Z-048A140	140	2.9167	2.875	
S1E64Z-048S144	S1E64Z-048A144	144	3.0000	2.958	
S1E64Z-048S156	S1E64Z-048A156	156	3.2500	3.208	

1-187
D820

REVISED:
6/26/23

1

R

T

1

2

3

4

5

6

7

8

9

10

11

12

13

14

15

16