

INTERNAL GEARS • 96 & 72 PITCH



AGMA 10
1/8 FACE
20° PRESSURE ANGLE

PHONE: 516.328.3300 • FAX: 516.326.8827 • WWW.SDP-SI.COM

> MATERIAL:

303 Stainless Steel
2024-T4 Aluminum, Chromic anodized before cutting.

Available on special order:
14-1/2° P.A., teeth not listed,
different material, passivation
for Stainless Steel.

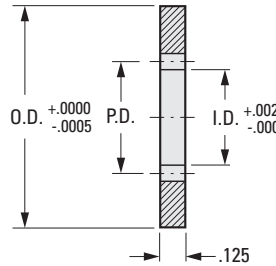
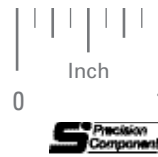
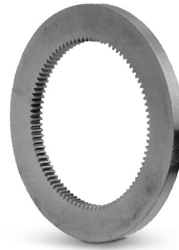

INCH COMPONENT

Catalog Number		No. of Teeth	P.D.	I.D.	O.D.
Stainless Steel	Aluminum				
96 Pitch					
S1E62Z-096S080	S1E62Z-096A080	80	.8333	.813	1.998
S1E62Z-096S100	S1E62Z-096A100	100	1.0417	1.021	
S1E62Z-096S120	S1E62Z-096A120	120	1.2500	1.229	
S1E62Z-096S140	S1E62Z-096A140	140	1.4583	1.438	
S1E62Z-096S150	S1E62Z-096A150	150	1.5625	1.542	
S1E63Z-096S150	S1E63Z-096A150	150	1.5625	1.542	2.998
S1E63Z-096S160	S1E63Z-096A160	160	1.6667	1.646	
S1E63Z-096S180	S1E63Z-096A180	180	1.8750	1.854	
S1E63Z-096S200	S1E63Z-096A200	200	2.0833	2.063	
S1E63Z-096S240	S1E63Z-096A240	240	2.5000	2.479	
S1E64Z-096S240	S1E64Z-096A240	240	2.5000	2.479	3.998
S1E64Z-096S250	S1E64Z-096A250	250	2.6042	2.583	
S1E64Z-096S260	S1E64Z-096A260	260	2.7083	2.688	
S1E64Z-096S280	S1E64Z-096A280	280	2.9167	2.896	
S1E64Z-096S288	S1E64Z-096A288	288	3.0000	2.979	
S1E64Z-096S300	S1E64Z-096A300	300	3.1250	3.104	
72 Pitch					
S1E62Z-072S060	S1E62Z-072A060	60	.8333	.805	1.998
S1E62Z-072S080	S1E62Z-072A080	80	1.1111	1.083	
S1E62Z-072S100	S1E62Z-072A100	100	1.3889	1.361	
S1E62Z-072S110	S1E62Z-072A110	110	1.5278	1.500	
S1E63Z-072S110	S1E63Z-072A110	110	1.5278	1.500	
S1E63Z-072S120	S1E63Z-072A120	120	1.6667	1.639	2.998
S1E63Z-072S140	S1E63Z-072A140	140	1.9444	1.916	
S1E63Z-072S160	S1E63Z-072A160	160	2.2222	2.194	
S1E63Z-072S180	S1E63Z-072A180	180	2.5000	2.472	
S1E64Z-072S180	S1E64Z-072A180	180	2.5000	2.472	
S1E64Z-072S190	S1E64Z-072A190	190	2.6389	2.611	3.998
S1E64Z-072S200	S1E64Z-072A200	200	2.7778	2.750	
S1E64Z-072S216	S1E64Z-072A216	216	3.0000	2.972	
S1E64Z-072S220	S1E64Z-072A220	220	3.0556	3.027	

1-186
D820

REVISED:
6/26/23

1

R

T

1

2

3

4

5

6

7

8

9

10

11

12

13

14

15

16