

# DIFFERENTIAL END GEARS • 48 PITCH

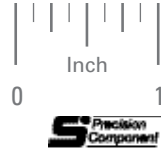

AGMA 12  
3/16 FACE  
1-1/8 BORE  
20° PRESSURE ANGLE

PHONE: 516.328.3300 • FAX: 516.326.8827 • WWW.SDP-SI.COM



**> MATERIAL:**

- 303 Stainless Steel
- 2024 Aluminum, Anodized before hobbing

The end gears shown on this page will be assembled, free of charge, to differentials that are ordered at the same time.

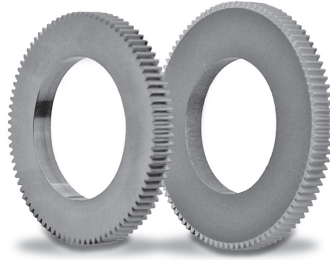

Available on special order:  
14-1/2° P.A., teeth not listed, different bore size and/or material, passivation for Stainless Steel.

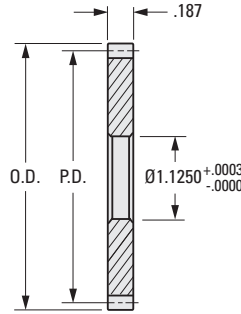

## INCH COMPONENT

Catalog Number		No. of Teeth	P.D.	O.D.
303 Stainless Steel	2024 Aluminum Anodized			
S1289Z-048S069C	S1289Z-048A069C	69	1.4375	1.4792
S1289Z-048S072C	S1289Z-048A072C	72	1.5000	1.5417
S1289Z-048S080C	S1289Z-048A080C	80	1.6667	1.7083
S1289Z-048S082C	S1289Z-048A082C	82	1.7083	1.7500
S1289Z-048S086C	S1289Z-048A086C	86	1.7917	1.8333
S1289Z-048S090C	S1289Z-048A090C	90	1.8750	1.9167
S1289Z-048S095C	S1289Z-048A095C	95	1.9792	2.0208
S1289Z-048S096C	S1289Z-048A096C	96	2.0000	2.0417
S1289Z-048S100C	S1289Z-048A100C	100	2.0833	2.1250
S1289Z-048S120C	S1289Z-048A120C	120	2.5000	2.5417

1-95  
D820

REVISED:  
6/14/23

- I
- R
- T
- 1**
- 2
- 3
- 4
- 5
- 6
- 7
- 8
- 9
- 10
- 11
- 12
- 13
- 14
- 15
- 16