

DIFFERENTIAL END GEARS • 72 PITCH

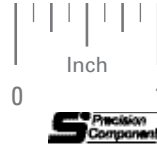

AGMA 12
1/8 FACE
11/16 BORE
20° PRESSURE ANGLE

PHONE: 516.328.3300 • FAX: 516.326.8827 • WWW.SDP-SI.COM



MATERIAL:
303 Stainless Steel
2024 Aluminum, Anodized
T4 or T351 Aluminum Alloy, anodized before cutting

The end gears shown on this page will be assembled, free of charge, to differentials which are ordered at the same time.

Available on special order:
14-1/2° P.A., teeth not listed, different bore size and/or material, passivation for Stainless Steel.

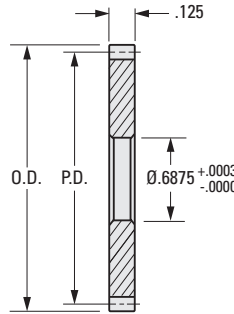

INCH COMPONENT

Catalog Number		No. of Teeth	P.D.	O.D.
303 Stainless Steel	2024 Aluminum Anodized			
S1269Z-072S070C	S1269Z-072A070C	70	.9722	1.0000
S1269Z-072S072C	S1269Z-072A072C	72	1.0000	1.0278
S1269Z-072S090C	S1269Z-072A090C	90	1.2500	1.2778
S1269Z-072S096C	S1269Z-072A096C	96	1.3333	1.3611
S1269Z-072S100C	S1269Z-072A100C	100	1.3889	1.4167
S1269Z-072S120C	S1269Z-072A120C	120	1.6667	1.6944
S1269Z-072S130C	S1269Z-072A130C	130	1.8056	1.8333
S1269Z-072S140C	S1269Z-072A140C	140	1.9444	1.9722
S1269Z-072S144C	S1269Z-072A144C	144	2.0000	2.0278

1-53
D820

REVISED:
6/14/23

- I
- R
- T
- 1
- 2
- 3
- 4
- 5
- 6
- 7
- 8
- 9
- 10
- 11
- 12
- 13
- 14
- 15
- 16