

AGMA 10
1/16 FACE
1/8 BORE
20° PRESSURE ANGLE

PHONE: 516.328.3300 • FAX: 516.326.8827 • WWW.SDP-SI.COM

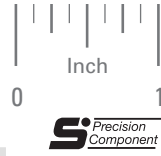

> MATERIAL:

- 303 Stainless Steel
- 2024 Aluminum, Anodized
- T4 or T351 Aluminum Alloy, anodized before cutting

Available on special order:
14-1/2° P.A., teeth not listed, different bore size and/or material, passivation for Stainless Steel.

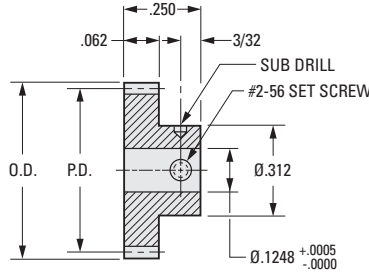
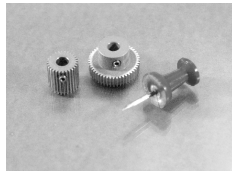
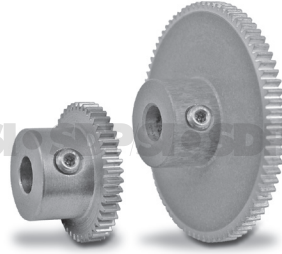

INCH COMPONENT

Catalog Number		No. of Teeth	P.D.	O.D.
303 Stainless Steel	2024 Aluminum Anodized			
S1023Z-096S024	S1023Z-096A024	24 Δ	.2500	.271
S1023Z-096S030	S1023Z-096A030	30 Δ	.3125	.333
S1023Z-096S035	S1023Z-096A035	35	.3646	.385
S1023Z-096S036	S1023Z-096A036	36	.3750	.396
S1023Z-096S038	S1023Z-096A038	38	.3958	.417
S1023Z-096S040	S1023Z-096A040	40	.4167	.438
S1023Z-096S045	S1023Z-096A045	45	.4688	.490
S1023Z-096S050	S1023Z-096A050	50	.5208	.542
S1023Z-096S052	S1023Z-096A052	52	.5417	.563
S1023Z-096S054	S1023Z-096A054	54	.5625	.583
S1023Z-096S055	S1023Z-096A055	55	.5729	.594
S1023Z-096S056	S1023Z-096A056	56	.5833	.604
S1023Z-096S060	S1023Z-096A060	60	.6250	.646
S1023Z-096S064	S1023Z-096A064	64	.6667	.688
S1023Z-096S065	S1023Z-096A065	65	.6771	.698
S1023Z-096S070	S1023Z-096A070	70	.7292	.750
S1023Z-096S072	S1023Z-096A072	72	.7500	.771
S1023Z-096S075	S1023Z-096A075	75	.7813	.802
S1023Z-096S080	S1023Z-096A080	80	.8333	.854
S1023Z-096S082	S1023Z-096A082	82	.8542	.875
S1023Z-096S085	S1023Z-096A085	85	.8854	.906
S1023Z-096S090	S1023Z-096A090	90	.9375	.958
S1023Z-096S095	S1023Z-096A095	95	.9896	1.010
S1023Z-096S096	S1023Z-096A096	96	1.0000	1.021
S1023Z-096S100	S1023Z-096A100	100	1.0417	1.063
S1023Z-096S105	S1023Z-096A105	105	1.0938	1.115
S1023Z-096S108	S1023Z-096A108	108	1.1250	1.146

Δ Hob cuts into hub. Hub diameter never exceeds gear O.D.

- I
- R
- T
- 1
- 2
- 3
- 4
- 5
- 6
- 7
- 8
- 9
- 10
- 11
- 12
- 13
- 14
- 15
- 16