

> **MATERIAL:**
Carbon Steel

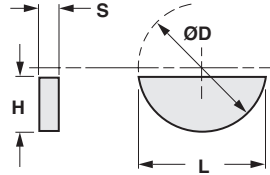

METRIC COMPONENT

Catalog Number	Width		Height		L Length	D Dia.	For Shaft Dia.			
	S	Tol.	H	Tol.			Over	To		
A 9C49M01507	1.5	0/-0.025	2.6	0/-0.1	6.76	7	4	6		
A 9C49M02007	2		3.7				6	8		
A 9C49M02010	2	0/-0.025	5	0/-0.12	9.66	10	6	8		
A 9C49M02013			12.65		13					
A 9C49M02510	2.5	0/-0.025	3.7	0/-0.12	9.66	10	8	10		
A 9C49M03010	3		5						12.65	13
A 9C49M03013	3	0/-0.025	6.5	0/-0.15	15.72	16	8	10		
A 9C49M03016			7.5		18.57				19	
A 9C49M03019			5		12.65				13	
A 9C49M04013			6.5		0/-0.15				15.72	16
A 9C49M04016	4	0/-0.03	7.5	0/-0.15	18.57	19	10	12		
A 9C49M04019			9		0/-0.15				21.63	22
A 9C49M04022			6.5		15.72				16	
A 9C49M05016			7.5		0/-0.15				18.57	19
A 9C49M05019	5	0/-0.03	9	0/-0.15	21.63	22	12	17		
A 9C49M05022			10		24.49				25	
A 9C49M05025			9		0/-0.15				21.63	22
A 9C49M06022	6	0/-0.03	10	0/-0.15	24.49	25	17	22		
A 9C49M06025			11		0/-0.18				27.35	28
A 9C49M06028			11		0/-0.18				27.35	28
A 9C49M08028	8	0/-0.036	13	0/-0.18	31.43	32	22	30		
A 9C49M08032			13		31.43				32	
A 9C49M10032			13		31.43				32	
A 9C49M10045	10	0/-0.036	16	0/-0.18	43.08	45	30	38		