

SINGLE & DOUBLE JOINT
ZERO BACKLASH

PHONE: 516.328.3300 • FAX: 516.326.8827 • WWW.SDP-SI.COM

> MATERIAL:

Body - 303 Stainless Steel
Balls - 440 Stainless Steel

> LUBRICATION:

Dry Film Plus Oil Suspension

> FEATURES:

Zero backlash through use of precision balls and burnished sockets
Sealed-in lubrication
Lightweight
Low inertia

> SPECIFICATIONS:

Torque Ratings - For static conditions with in-line loading, maximum load being one which causes joint to yield.

Max. Operating Angle - Fig. 1: 30° @ 4000 rpm
Fig. 2: 60° @ 4000 rpm

Set screws available on special order.

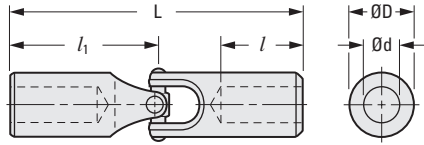

Fig. 1

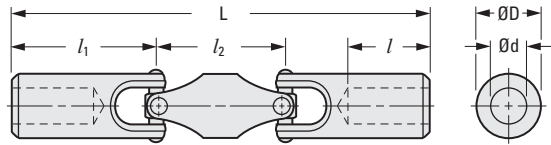

Fig. 2

METRIC COMPONENT

Catalog Number	D Dia.	d Bore +0.013 0	l Bore Depth	l ₁ End Unit	l ₂ Center	L Length	Torque N • m
Fig. 1 Single Joint							
S57PY5MSU0005	4.76	Solid	—	12.7	—	25.4	0.11
S57PY5MSU0205	4.76	2.5	8.7	12.7		25.4	0.11
S57PY5MSU0305		3					
S57PY5MSU0407	7.15	4	11.1	17.5		34.9	0.45
S57PY5MSU0507		5					
S57PY5MSU0510	9.53	5	12.7	22.2		44.5	1.8
S57PY5MSU0610		6					
Fig. 2 Double Joint							
S57PY5MDU0205	4.76	2.5	8.7	12.7	12.7	38.1	0.11
S57PY5MDU0305		3					
S57PY5MDU0407	7.15	4	11.1	17.5	15.9	50.8	0.45
S57PY5MDU0507		5					
S57PY5MDU0510	9.53	5	12.7	22.2	19.1	63.5	1.8
S57PY5MDU0610		6					

