

SLEEVE TYPE FLEXIBLE COUPLINGS

SDPSI

> MATERIAL:

- Sleeve - Polyethylene
- Insert - Acetal
- Hubs - Aluminum Alloy, Anodized

PHONE: 516.328.3300 • FAX: 516.326.8827 • WWW.SDP-SI.COM



> SPECIFICATIONS:

	Series	
	21	23
Max. hp @ 1750 rpm	1/20	1/2
Max. Angular Offset	3°	7°
Max. Lateral Offset	0.12	0.35
Max. Torque N • m	0.07	2.03



> BUILD YOUR OWN COUPLING:

For Different Bore Combinations: Select insert and hub assemblies and corresponding sleeve within the same series.
For Hubs with the Same Bore: Select the "Complete Coupling"

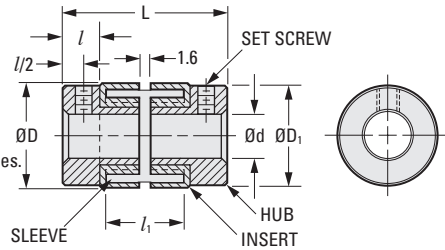

METRIC COMPONENT

Catalog Number			D Dia.	d Bore Dia. +0.025 0	L Length	l ₁ Sleeve Length	D ₁ Hub Dia.	l Hub Length	Set Screw
Complete Coupling	Insert & Hub Assembly	Sleeve Only							
A 5Z21M1304	A 5T21M1304	A 5R21M13	14.7	4	23.8	11	14.3	5.6	M2.5
A 5Z21M1305	A 5T21M1305			5					M3
A 5Z21M1306	A 5T21M1306			6					M3
A 5Z23M2508	A 5T23M2508	A 5R23M25	27.4	8	39.7	17.5	25.4	9.5	M5
A 5Z23M2510	A 5T23M2510			10					M6
A 5Z23M2512	A 5T23M2512			12					M6

Sleeve Stock Catalog Number	O.D.	Length
A 5R23M25S	25	300

