

# INTEGRAL CLAMP HI-FLEX BELLOWS COUPLINGS

# SDPSI

TORQUE RANGE FROM 7.1 TO 245.3 N • cm  
 ZERO BACKLASH  
 ZERO CYCLIC SPEED VARIATION DURING 360° ROTATION  
 VERY LOW TORSIONAL DEFLECTION

PHONE: 516.328.3300 • FAX: 516.326.8827 • WWW.SDP-SI.COM



### > MATERIAL:

- Hubs - Aluminum
- Bellows - Flexible Electrodeposited Nickel
- Cap Screws - Steel, Black Oxide

### > FOR APPLICATIONS REQUIRING:

- Precise Adjustment
- Repositioning
- Reversal Torque Resistance
- Vibration Resistance
- Ability to Handle Large Shaft Misalignment

Other bores, finishes are available upon special order

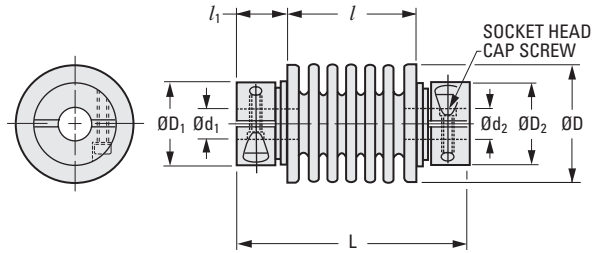

### METRIC COMPONENT

Catalog Number	d <sub>1</sub> Bore H8	d <sub>2</sub> Bore H8	D <sub>1</sub> Hub Dia.	D <sub>2</sub> Hub Dia.	l Bellows Length	l <sub>1</sub> Hub Width	L Overall Length	D Bellows O.D.	Cap Screws
S9901YMG020223	2	2	10.5	10.5	11.43	5.7	22.83	9.5	M1.6
S9901YMG020323		3							
S9901YMG030323	3	3	10.5	10.5	11.43	5.7	22.83	9.5	M1.6
S9901YMG030423	3	4							
S9901YMG040423	4	4	12	12	13.06	6.5	26.06	11.1	M2
S9901YMG020226	2	2							
S9901YMG020326	2	3	12	12	13.06	6.5	26.06	11.1	M2
S9901YMG040426	4	4							
S9901YMG040626	4	4	12	14.5	13.06	6.5	26.06	11.1	M2
S9901YMG060626	6	6							
S9901YMG040428	4	4	12	12	14.76	6.5	27.76	16.3	M2
S9901YMG040628		6	6	14.5	14.5	14.76	6.5	27.76	16.3
S9901YMG060628	6	6	14.5	14.5	14.76	6.5	27.76	16.3	M2
S9901YMG060630			15.5	15.5	15.75	7.2	30.15	19.1	M2.5
S9901YMG061030	6	10	15.5	22	15.75	7.2	30.15	19.1	M2.5
S9901YMG101030	10								
S9901YMG101035	10	10	22	22	20.55	7.2	34.95	25	M2.5
S9901YMG101235	10	12							
S9901YMG121235	12	12							

Coupling Series (Ref.)	Max. Rated Instantaneous Torque N • cm	Max. Misalignment		Max. Axial Extension	Max. Axial Compression	Side Force N/mm	Torsional Deflection Arc Sec./ N • cm	Spring Rate N/mm
		Angular Offset	Lateral Offset					
S9901YM...23	7.1	13°	0.4	1.3	1.7	6.3	94.7	3.1
S9901YM...26	9.6	14°	0.53	1.67	2.23	4.1	74.9	2.2
S9901YM...28	37.4	10°	0.42	1.71	2.28	12.1	20.2	4
S9901YM...30	131.4	8°	0.36	1.58	2.1	36.9	8.8	10.3
S9901YM...35	245.3	8°	0.46	2	2.66	38	4.5	11.2