

EQUIVALENT TO THE STANDARD FOR
 RECIRCULATING BALL BEARING
 SELF-LUBRICATING
 OPEN, ANODIZED ALUMINUM HOUSING
 FOR SUPPORTED SHAFTS
 MAINTENANCE-FREE
 SECURE BEARING WITH SET SCREWS
 (NOT INCLUDED)

PHONE: 516.328.3300 • FAX: 516.326.8827 • WWW.SDP-SI.COM



› MATERIAL:

Body - Aluminum, Anodized
Liner - J® Polymer

› OPERATING TEMPERATURE:

Continuous: -14°C to +90°C
Intermittent: up to +120°C

› SHAFT REQUIREMENTS:

Hard anodized aluminum, 8-16 RMS surface finish. Other materials such as stainless steel, ceramic, case-hardened steel & chrome plated steel can be used, but if hardness is below HRC 50 and surface finish is outside 8-16 RMS, overall service life may be affected.

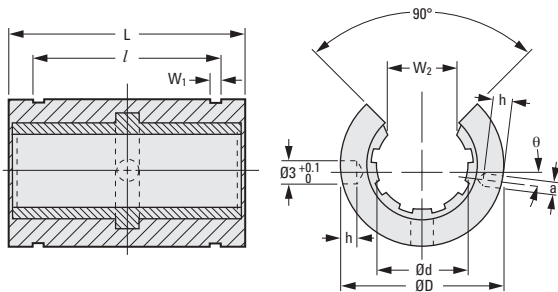

The projections shown are per ISO convention.

› SPECIFICATIONS:

d Tolerance:	Δ Housing Bore Tolerance:
10 to 16 mm +0.088/+0.030	19 to 26 mm +0.021/0
20 & 25 mm +0.091/+0.030	32 to 47 mm +0.025/0
30 mm +0.110/+0.040	62 & 75 mm +0.030/0
40 mm +0.115/+0.040	
50 mm +0.130/+0.050	

Recommended for use with shafts,
 Catalog Number: **S40AW6M...**

METRIC COMPONENT

Catalog Number	d Bore	D Δ Dia.	L Length ± 0.3	l Groove Distance	W ₁ Groove Width	W ₂	a +0.1 0
S99GLZM1019029	10	19	29	21.6	1.3	7.3	—
S99GLZM1222032	12	22	32	22.6		9	3
S99GLZM1626036	16	26	36	24.6	1.6	11.6	2.2
S99GLZM2032045	20	32	45	31.2		12	
S99GLZM2540058	25	40	58	43.7	1.85	14.5	3
S99GLZM3047068	30	47	68	51.7		16.6	
S99GLZM4062080	40	62	80	60.3	2.15	21	3
S99GLZM5075100	50	75	100	77.3	2.65	25.5	5

Catalog Number (Ref.)	θ	h 0 -0.5	Load Capacity					
			Dynamic p = 51 kgf / cm ²			Static p = 356.8 kgf / cm ²		
			0°	90°	180°	0°	90°	180°
S99GLZM1019029	—	1.2	163	112	44	1141	766	308
S99GLZM1222032	7°		215	142	54	1510	999	377
S99GLZM1626036	—	1.2	323	222	89	2266	1560	623
S99GLZM2032045	—		505	404	202	3540	2832	1416
S99GLZM2540058	-4.3°	1.5	815	663	342	5704	4646	2396
S99GLZM3047068	4.9°		1146	955	512	8025	6684	3584
S99GLZM4062080	2.8°	2	1798	1530	854	12588	10714	5993
S99GLZM5075100	3.8°		2810	2413	1377	19670	16919	13769

