

WON'T MAR SHAFT

PHONE: 516.328.3300 • FAX: 516.326.8827 • WWW.SDPSI.COM

**> MATERIAL:**  
Stainless Steel

**> SPECIFICATIONS:**  
O.D. Tolerance:  
8 & 10 mm 0/-0.015  
12 to 17 mm 0/-0.018  
20 to 28 mm 0/-0.021

Bore Tolerance:  
4 to 6 mm +0.012/0  
7 to 10 mm +0.015/0  
11 to 17 mm +0.018/0  
19 & 20 mm +0.021/0

Tolerance for diameters are before slitting.

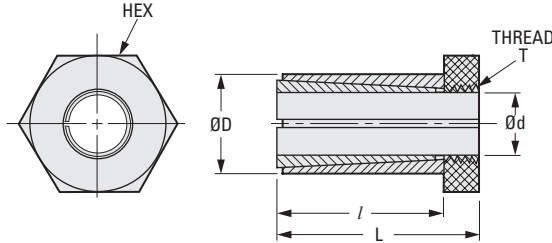
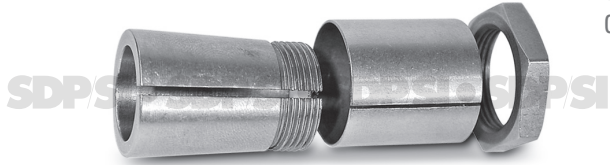

The projections shown are per ISO convention.

**METRIC COMPONENT**

Catalog Number	d Bore H7	D Dia. h7	l	L ± 0.1	Hex Across Flats	T	Max. Torque N • m (lb • in)
S99TBSM04	4 (.157)	8 (.315)	12.5 (.492)	15 (.591)	8 (.315)	M6x0.5	3 (26.6)
S99TBSM05	5 (.197)	10 (.394)	12.5 (.492)	15 (.591)	10 (.394)	M8x0.5	4 (35.4)
S99TBSM06	6 (.236)	12 (.472)	12 (.472)	15 (.591)	12 (.472)	M10x0.75	7 (62.0)
S99TBSM07	7 (.276)	14 (.551)	12 (.472)	15 (.591)	12 (.472)	M10x0.75	8 (70.8)
S99TBSM08	8 (.315)	17 (.669)	18.5 (.728)	22 (.866)	19 (.748)	M15x1	14 (123.9)
S99TBSM09	9 (.354)	20 (.787)	23 (.906)	28 (1.102)	22 (.866)	M17x1	24 (212.4)
S99TBSM10	10 (.394)	23 (.906)	23 (.906)	28 (1.102)	27 (1.063)	M20x1	26 (230.1)
S99TBSM11	11 (.433)	25 (.984)	23 (.906)	28 (1.102)	27 (1.063)	M22x1	29 (256.7)
S99TBSM12	12 (.472)	28 (1.102)	23 (.906)	28 (1.102)	30 (1.181)	M25x1	31 (274.4)
S99TBSM13	14 (.551)						
S99TBSM14	15 (.591)						
S99TBSM15	16 (.630)						
S99TBSM16	17 (.669)						
S99TBSM17	19 (.748)						
S99TBSM18	20 (.787)						

**NOTE:** Dimensions in ( ) are inch.

