

USED IN LINEAR DRIVES

PHONE: 516.328.3300 • FAX: 516.326.8827 • WWW.SDP-SI.COM

**> MATERIAL:**

Aluminum

**> SPECIFICATIONS:**

**Timing Belt Clamp Kit includes:**

Top and Bottom Plate and Hardware for Assembly

**Hardware for kit includes:**

Screws, Washers and Hex Nuts for Assembly

**For Replacement hardware kit, order:**

**A16A25MBOLTKIT** HTD®5 mm pitch

**A16A28MBOLTKIT** HTD®8 mm pitch



5 mm Pitch						
F mm (in.)	M mm (in.)	S mm (in.)	H mm (in.)	K mm (in.)	X mm (in.)	S <sub>1</sub> mm (in.)
7.5 (.295)	10 (.394)	8 (.315)	10 (.394)	25 (.984)	5 (.197)	10 (.394)
8 mm Pitch						
10 (.394)	16 (.630)	15 (.591)	15 (.591)	40 (1.574)	8 (.315)	16 (.630)

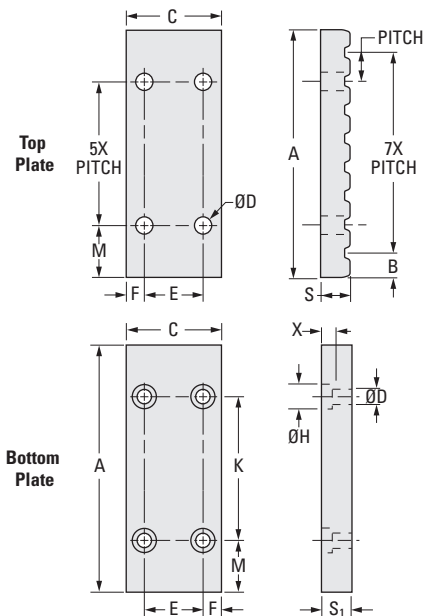

**METRIC COMPONENT**

Catalog Number	Belt Width mm (in.)	A mm (in.)	B mm (in.)	C mm (in.)	D mm (in.)	E mm (in.)	Toothed + Flat Plate Total Weight (with hardware) kg (lb.)
<b>HTD® • 5 mm Pitch - Sold as Kit</b>							
A16A25M09	6 (.236) & 9 (.354)	45 (1.772)	5 (.197)	31.5 (1.24)	5.5 (.217)	16.5 (.650)	0.068 (.15)
A16A25M15	15 (.591)	45 (1.772)	5 (.197)	36.5 (1.44)	5.5 (.217)	21.5 (.846)	0.068 (.15)
A16A25M25	25 (.984)	45 (1.772)	5 (.197)	46.5 (1.83)	5.5 (.217)	31.5 (1.24)	0.100 (.22)
<b>HTD® • 8 mm Pitch - Sold as Kit</b>							
A16A28M20	20 (.787)	72 (2.835)	8 (.315)	50.5 (1.988)	9 (.354)	30.5 (1.201)	0.272 (.60)
A16A28M30	30 (1.181)	72 (2.835)	8 (.315)	60.5 (2.382)	9 (.354)	40.5 (1.594)	0.331 (.73)
A16A28M50	50 (1.969)	72 (2.835)	8 (.315)	80.5 (3.169)	9 (.354)	60.5 (2.382)	0.449 (.99)