

> **MATERIAL:**

303 Stainless Steel

PHONE: 516.328.3300 • FAX: 516.326.8827 • WWW.SDP-SI.COM

> **SPECIFICATION:**

d bore and mounting diameter are concentric to 0.008 mm.

Available on special order:  
Hubs assembled to gears or dials, passivation.



SDPSI • SDPSI • SDPSI • SDPSI

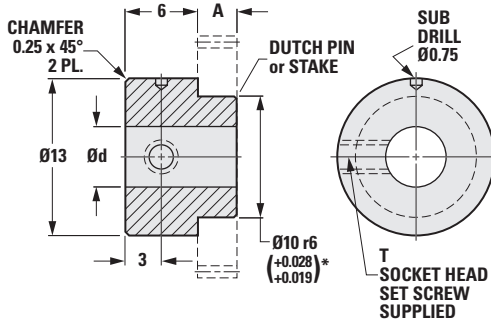

The projections shown are per ISO convention.

**METRIC COMPONENT**

| Catalog Number | A   | d Bore H7 | d Tolerance | T Set Screw |
|----------------|-----|-----------|-------------|-------------|
| S200MYM016025  | 1.6 | 2.5       | +0.01/0     | M2          |
| S200MYM032025  | 3.2 |           |             |             |
| S200MYM016030  | 1.6 | 3         | +0.01/0     | M2          |
| S200MYM032030  | 3.2 |           |             |             |
| S200MYM016040  | 1.6 | 4         | +0.012/0    | M2          |
| S200MYM032040  | 3.2 |           |             |             |
| S200MYM016050  | 1.6 | 5         | +0.012/0    | M3          |
| S200MYM032050  | 3.2 |           |             |             |
| S200MYM016060  | 1.6 | 6         | +0.012/0    | M3          |
| S200MYM032060  | 3.2 |           |             |             |
| S200MYM016080  | 1.6 | 8         | +0.015/0    | M3          |
| S200MYM032080  | 3.2 |           |             |             |

\* To provide press fit, use tolerance according to H7 for the mating part bore diameter.

- 1
- 2
- 3
- 4
- 5
- 6
- 7
- 8
- 9
- 10
- 11
- 12
- 13
- 14
- 15
- 16