

# SINGLE DISK FLEXIBLE COUPLINGS

**SDP/SI**

SPLIT HUB TYPE  
ZERO BACKLASH  
HIGH TORSIONAL STIFFNESS  
MAINTENANCE-FREE

PHONE: 516.328.3300 • FAX: 516.326.8827 • WWW.SDP-SI.COM



**> MATERIAL:**

**Pins & Disks** - Stainless Steel  
**Hubs & Spacer** - Aluminum Alloy

**> MISALIGNMENT COMPENSATION:**

**Max. Angular Offset:** .7°  
**Max. Lateral Offset:** 0  
**Max. Axial Motion:** ± .008

**> SPECIFICATION:**

Shaft Tolerance:  
.1875 +.0000/- .0005  
.2500 & .3750 +.0000/- .0006  
.5000 & .6250 +.0000/- .0007  
.7500 & 1.0000 +.0000/- .0008

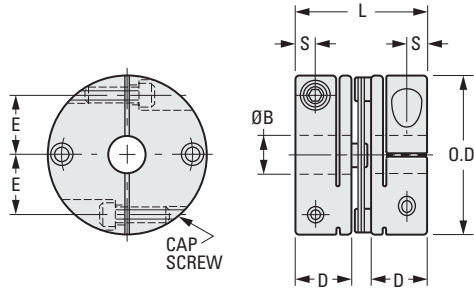

**INCH COMPONENT**

Catalog Number	O.D.	B Bore	S	L	D	E	Cap Screw	Max.* Bore
S50MDS-074H18H18	.748	.1875	.098	.787	.315	.256	#2-56	.315
S50MDS-074H25H25		.2500						
S50MDS-098H25H25	.984	.2500	.138	.945	.394	.354	#4-40	.472
S50MDS-098H37H37		.3750						
S50MDS-126H37H37	1.260	.3750	.157	1.142	.472	.433	#6-32	.591
S50MDS-126H50H50		.5000						
S50MDS-157H50H50	1.575	.5000	.197	1.299	.551	.591	#10-24	.787
S50MDS-157H62H62		.6250						
S50MDS-196H62H62	1.969	.6250	.236	1.654	.709	.709	#10-24	.984
S50MDS-196H75H75		.7500						
S50MDS-248H75H75	2.480	.7500	.276	1.811	.787	.945	1/4-20	1.181
S50MDS-248H99H99		1.0000						

\* Other bore diameter combinations and bore sizes not exceeding the maximum listed above are available on special order.

Coupling Series (Ref. Only)	Torque lbf in.	Max. rpm	Moment of Inertia oz. in. <sup>2</sup>	Static Torsional Stiffness lbf in. / deg	Weight oz.
S50MDS-074H...	6.20	10000	.034	43.26	.32
S50MDS-098H...	8.85	8000	.115	97.33	.67
S50MDS-126H...	22.13	6000	.394	247.20	1.45
S50MDS-157H...	30.98	5000	.711	401.70	2.40
S50MDS-196H...	79.66	4000	3.334	478.95	4.94
S50MDS-248H...	110.64	3000	9.295	648.90	8.82

6-48  
D820

REV:  
4/27/23

- I
- R
- T
- 1
- 2
- 3
- 4
- 5
- 6
- 7
- 8
- 9
- 10
- 11
- 12
- 13
- 14
- 15
- A