

PIN TYPE

PHONE: 516.328.3300 • FAX: 516.326.8827 • WWW.SDP-SI.COM

› **MATERIAL:**

Housing - 303 Stainless Steel
Brake - Oil-Impregnated Steel

› **TORQUE:**

5-50 ozf in.

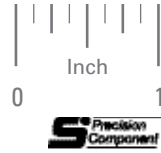

Other bores available on special order.

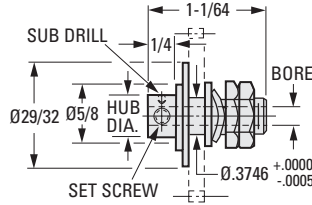

INCH COMPONENT

Catalog Number	Bore +.0005 -.0000	Hub Diameter	Set Screw	Sub Drill
S9906A-G150S-1	.1200	.312	#2-56	.029
S9906A-G150S-2	.1248			
S9906A-G150S-3	.1873	.375	#4-40	.040
S9906A-G150S-4	.2498	.500	#6-32	.070

NOTE: Use with Hubless Gears of .125 F.W. and .3750

CLAMP TYPE

› **MATERIAL:**

Housing - 303 Stainless Steel
Brake - Oil-Impregnated Steel

› **TORQUE:**

5-50 ozf in.



Other bores available on special order.

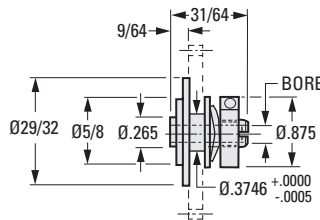

INCH COMPONENT

Catalog Number	Bore +.0005 -.0000
S9906A-G150-1	.1200
S9906A-G150-2	.1248
S9906A-G150-3	.1873
S9906A-G150-4	.2498

NOTE: Use with Hubless Gears of .125 F.W. and .3750

- I
- R
- T
- 1
- 2
- 3
- 4
- 5
- 6
- 7
- 8
- 9
- 10
- 11
- 12
- 13
- 14
- 15
- 16