

TAPERED GROOVE PIN

(3 tapered grooves extending half the length of the pin)

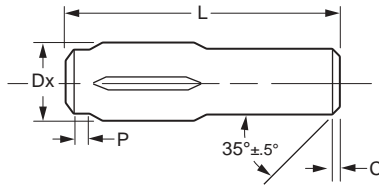
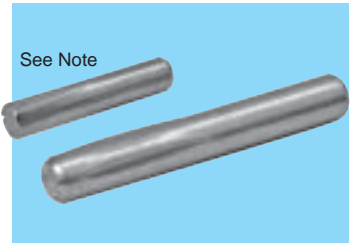

PARALLEL GROOVE PIN

(3 parallel grooves extending half the length of the pin)

MATERIAL: Carbon Steel

FINISH: Zinc Plated

Priced Per 1000 Pieces

Catalog Number	D Diameter		Dx Expanded Diameter		L Length ±.01	P (Ref.)	C Chamfer Length Min.
	Min.	Max.	Min.	Max.			
* A 9C37-0208	.061	.062	.067	.069	.25	1/32	.005
A 9C37-0212					.375		
A 9C37-0216					.50		
A 9C37-0220					.625		
A 9C37-0224					.75		
A 9C37-0228					.875		
A 9C37-0232	1.00						
A 9C37-0308	.093	.094	.100	.102	.25	1/32	.005
* A 9C37-0312					.375		
A 9C37-0316					.50		
* A 9C37-0320					.625		
A 9C37-0324	.75						
A 9C37-0412	.123	.125	.132	.136	.375	1/32	.005
A 9C37-0416					.50		
A 9C37-0428					.875		
A 9C37-0432					1.00		
A 9C37-0440					1.250		
A 9C37-0528					.875		
* A 9C37-0612	.180	.188	.196	.200	.375	1/16	.016
* A 9C37-0616					.50		
* A 9C37-0624					.75		
* A 9C37-0628					.875		
* A 9C37-0664					2.00		

NOTE: The tapered groove pin style shown above will be replaced by a parallel groove type when current stock is depleted.

*To be discontinued when present stock is depleted.