

# CYLINDRICAL MOUNTINGS • TO 105 lbf



FOR COMPRESSION LOADS OF 47 TO 105 lbf  
SHEAR LOADS OF 27 TO 66 lbf

PHONE: 516.328.3300 • FAX: 516.326.8827 • WWW.SDP-SI.COM

**> MATERIAL:**

**Fastener** - Steel, Zinc Plated  
**Isolator** - Natural Rubber

**> LOAD DEFLECTION GRAPHS:**

Deflections below the line x-x are considered safe practice for static loads; data above that line are useful for calculating deflections under dynamic loads.

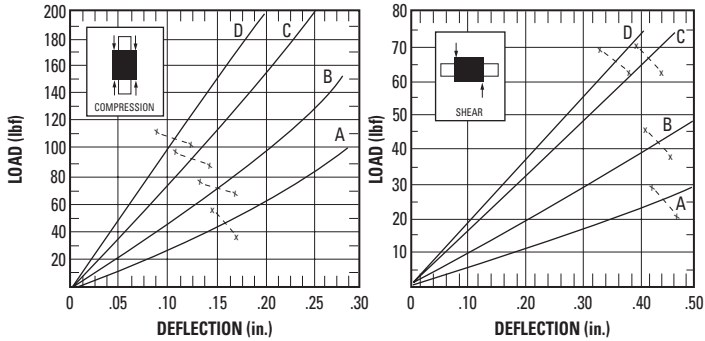
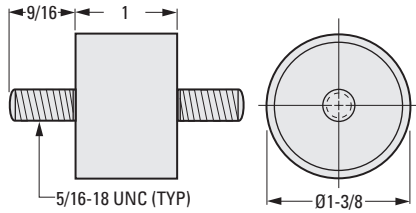

**INCH COMPONENT CATALOG NUMBER**

A 10Z 2-311

Load Rating  
A, B, C or D

Compression		Forcing Frequency in Cycles per Minute									
Load Rating	Maximum Load lbf	700	850	1100	1250	1500	1750	2000	2250	2500	3000
		Minimum Load for 81% Isolation (lbf)									
A	47	—	—	—	44.5	30.0	22.0	18.0	13.5	11.0	—
B	74	—	—	—	72.5	48.5	35.5	27.0	21.0	17.5	12.5
C	96	—	—	—	—	75.7	55.5	43.0	34.0	28.0	19.5
D	105	—	—	—	—	100.0	73.0	56.5	45.0	38.0	25.5

Shear		Forcing Frequency in Cycles per Minute									
Load Rating	Maximum Load lbf	700	850	1100	1250	1500	1750	2000	2250	2500	3000
		Minimum Load for 81% Isolation (lbf)									
A	27	27.0	19.5	11.5	9.0	6.0	*	*	*	*	*
B	41	—	31.0	19.0	14.5	10.5	8.0	*	*	*	*
C	66	—	53.5	33.0	26.5	19.0	14.0	11.5	9.0	*	*
D	66	—	61.0	38.0	30.5	22.0	19.5	13.0	10.5	8.5	*

\* At these forcing frequencies, lesser loads will yield less than 81% isolation.

