

SPLIT HUB TYPE

PHONE: 516.328.3300 • FAX: 516.326.8827 • WWW.SDP-SI.COM

> MATERIAL:

Hubs - Aluminum, Clear Anodized
Torque Disc - Acetal



> MISALIGNMENT COMPENSATION:

Max. Angular Offset: .5°

> OPERATING TEMPERATURE:

-40°F to +185°F

> FEATURES:

Easy assembly.
 Lubrication-free.
 Low inertia.
 Corrosion-resistant.
 Electrical isolation.

> MAX. SERVICE TORQUE:

6.6 lbf in. for 15 series
 15.0 lbf in. for 19 series
 35.0 lbf in. for 25 series
 80.0 lbf in. for 33 series



> BUILD YOUR OWN COUPLING:

For Different Bore Combinations: Select hubs and corresponding disc within the same series.

For Hubs with the Same Bore: Select the "Complete Coupling"

Set Screw & Split Hubs can be interchanged if discs from the same size O.D. are selected.

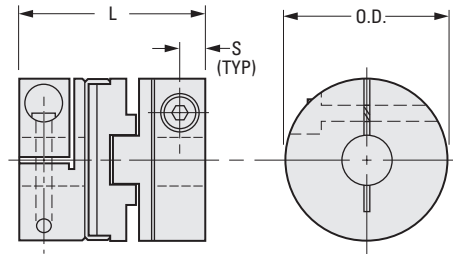

INCH COMPONENT			O.D.	Bore +0.030 0	L Length	Max. Shaft Depth	Cap Screw	Max. Lateral Offset	S
Catalog Number									
Complete Coupling	Hub Only	Disc Only							
A 5Z15-331504	A 5A15-331504	A 5P15-3315	.59	.125	1.02	.32	#3-48	.004	3/32
A 5Z15-331506	A 5A15-331506			.1875					
A 5Z15-331508	A 5A15-331508			.250					
A 5Z15-331904	A 5A15-331904	A 5P15-3319	.75	.125	.87	.25	#3-48	.008	3/32
A 5Z15-331906	A 5A15-331906			.1875					
A 5Z15-331908	A 5A15-331908			.250					
A 5Z15-332508	A 5A15-332508	A 5P15-3325	1.00	.250	1.12	.34	#6-32	.008	1/8
A 5Z15-332510	A 5A15-332510			.3125					
A 5Z15-332512	A 5A15-332512			.375					
A 5Z15-333310	A 5A15-333310	A 5P15-3333	1.31	.3125	1.89	.51	#6-32	.008	1/8
A 5Z15-333312	A 5A15-333312			.375					
A 5Z15-333316	A 5A15-333316			.500					

