

> MATERIAL:

Sleeve - Neoprene with Ground O.D.
Hubs - Zinc Alloy Die Casting

PHONE: 516.328.3300 • FAX: 516.326.8827 • WWW.SDP-SI.COM

> MISALIGNMENT COMPENSATION:

Max. Angular Offset: 7.5°

> OPERATING TEMPERATURE:

+250°F Max.

> FEATURES:

No lubrication.
 Electrically isolated.
 Dampens shock & vibration.

> BUILD YOUR OWN COUPLING:

For Different Bore Combinations: Select hubs and corresponding sleeve within the same series.
For Hubs with the Same Bore: Select the "Complete Coupling"

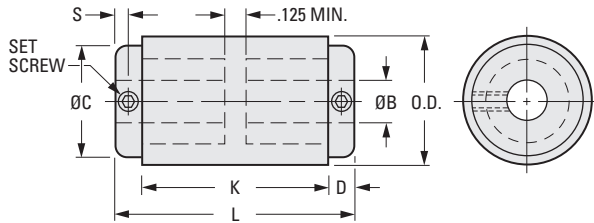
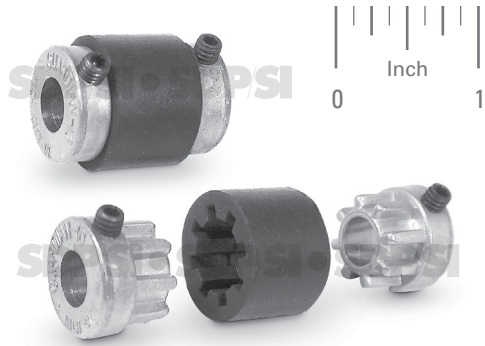

Coupling Series	Nominal Torque lbf in.	hp @ 1750 rpm	Max. Lateral Offset	Max. Speed rpm
11	4	.11	.016	25000
18	16	.44		16800
21	30	.83	.040	11500
31	60	1.7		15500

INCH COMPONENT

Catalog Number			O.D. ± .030	B Bore +.002 - .001	L ± .030	C Hub Dia.	D	K ± 1/16	S	Set Screw
Complete Coupling	Hub Only	Sleeve Only								
A 5Z 1-1104	A 5D 1-1104	A 5R 1-11	.80	.125	1	.70	7/32	.56	1/8	#6-32
A 5Z 1-1106	A 5D 1-1106			.188						
A 5Z 1-1108	A 5D 1-1108			.250						
A 5Z 1-1110	A 5D 1-1110			.3125						
A 5Z 1-1112	A 5D 1-1112			.375						
A 5Z 1-1810	A 5D 1-1810	A 5R 1-18	1.20	.3125	1-1/2	1.15	5/16	.85	5/32	1/4-20
A 5Z 1-1812	A 5D 1-1812			.375						
A 5Z 1-1814	A 5D 1-1814			.438						
A 5Z 1-1816	A 5D 1-1816			.500						
A 5Z 1-2110	A 5D 1-2110	A 5R 1-21	1.20	.3125	2-1/4	1.15	5/16	1-19/32	5/32	1/4-20
A 5Z 1-2112	A 5D 1-2112			.375						
A 5Z 1-2114	A 5D 1-2114			.438						
A 5Z 1-2116	A 5D 1-2116			.500						
A 5Z 1-3112	A 5D 1-3112	A 5R 1-31	1.40	.375	2-3/8	1.45	3/8	1-19/32	3/16	1/4-20
A 5Z 1-3114	A 5D 1-3114			.438						

