

> MATERIAL:

Spring - 1095 Steel
Hubs - Cold Rolled Steel

PHONE: 516.328.3300 • FAX: 516.326.8827 • WWW.SDP-SI.COM



> OPERATING TEMPERATURE:

250°F Max.

> MAXIMUM SPEED:

30000 rpm

> SPECIFICATION:

For all A 5C 5-18 Series, the diameter of the spring is the same as that of the hubs.

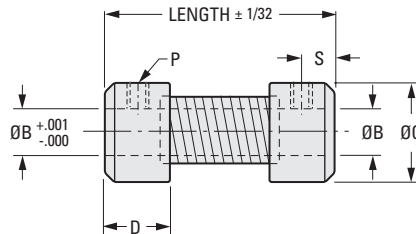

INCH COMPONENT

Catalog Number		B Bore (Thru)	Length		C Hub O.D.	D Hub Length	S	P Set Screw
Regular	Short		Regular	Short				
A 5C 5-1804	—	1/8	1	—	.61	5/16	5/32	#6-32
A 5C 5-1806	—	3/16						
A 5C 5-1808	—	1/4						
A 5C 5-2504	A 5C 6-2504	1/8	1-33/64	1	.73	3/8	5/32	#6-32
A 5C 5-2506	A 5C 6-2506	3/16						
A 5C 5-2508	A 5C 6-2508	1/4						
A 5C 5-2510	A 5C 6-2510	5/16						
A 5C 5-3708	A 5C 6-3708	1/4	2-1/16	1-43/64	.86	5/8	1/4	#10-24
A 5C 5-3712	A 5C 6-3712	3/8						
A 5C 5-5012	A 5C 6-5012	3/8	2-33/64	1-27/32	1.04	3/4	5/16	1/4-20
A 5C 5-5016	A 5C 6-5016	1/2						

Coupling Series (Ref. Only)	Max. Torque lbf in.	H.P. Per 100 rpm	Wind-up At Max. Torque	Max. Angular Offset At Zero Lateral Misalignment	Maximum Lateral Offset At Zero Angular Misalignment	Maximum Recommended Axial Motion
A 5C 5-18...	18	.03	1.80°	3.0°	.008	.010
A 5C 5-25...	34	.05	1.80°		.011	
A 5C 5-37...	39	.06	1.78°	4.5°		.014
A 5C 5-50...	82	.13	1.82°		.021	
A 5C 6-25...	34	.05	1.07°	3.0°		.007
A 5C 6-37...	39	.06	1.09°		.009	
A 5C 6-50...	82	.13	1.05°	3.0°		.014