



Flat Belts

■ POLYESTER

■ HIGH-SPEED

■ 1/4" WIDE

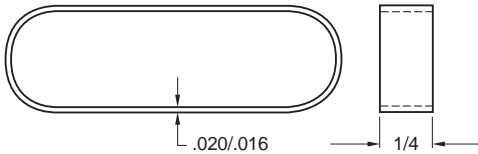

MATERIAL: 1 Ply Polyester Woven Cord, Black Neoprene Coating

SPECIFICATIONS: Maximum Belt Speed - 20000 fpm

Working Tension - 0.5 to 6 lbs.

Length Tolerance - $\pm 0.5\%$

Minimum Pulley Size - 1/4" Diameter

Breaking Strength - 250 lbs.

Catalog Number	Length	
	mm	Inch
A 6R19-16025	160	6.30
A 6R19-17025	170	6.69
A 6R19-18025	180	7.09
A 6R19-19025	190	7.48
A 6R19-20025	200	7.87
A 6R19-22525	225	8.86
A 6R19-25025	250	9.84
A 6R19-27525	275	10.83
A 6R19-30025	300	11.81
A 6R19-32525	325	12.80
A 6R19-35025	350	13.78
A 6R19-37525	375	14.76
A 6R19-40025	400	15.75
A 6R19-42525	425	16.73
A 6R19-47525	475	18.70
A 6R19-50025	500	19.69

Special Widths - cut to size from sleeves available from stock.