

AGMA 7

14-1/2° AND 20° PRESSURE ANGLE

PHONE: 516.328.3300 • FAX: 516.326.8827 • WWW.SDP-SI.COM

➤ MATERIAL:
Steel

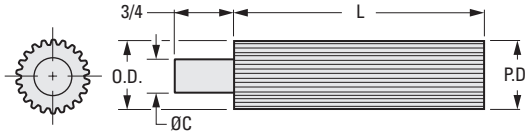

| INCH COMPONENT | | No. of Teeth | P.D. | O.D. | C Shank Dia. | L Minimum Usable Length |
|------------------------|--------------------|--------------|-------|-------|--------------|-------------------------|
| 14-1/2° Pressure Angle | 20° Pressure Angle | | | | | |
| 24 Pitch | | | | | | |
| A 1C29-N24012 | A 1C29-Y24012 | 12 | .500 | .583 | 1/4 | 3 |
| A 1C29-N24014 | A 1C29-Y24014 | 14 | .583 | .667 | 3/8 | |
| A 1C29-N24015 | A 1C29-Y24015 | 15 | .625 | .708 | | 3/8 |
| A 1C29-N24016 | A 1C29-Y24016 | 16 | .667 | .750 | | |
| A 1C29-N24018 | A 1C29-Y24018 | 18 | .750 | .833 | 1/2 | 8 |
| A 1C29-N24020 | A 1C29-Y24020 | 20 | .833 | .917 | | |
| A 1C29-N24024 | A 1C29-Y24024 | 24 | 1.000 | 1.083 | 3/4 | 8 |
| A 1C29-N24030 | A 1C29-Y24030 | 30 | 1.250 | 1.333 | | |
| A 1C29-N24036 | A 1C29-Y24036 | 36 | 1.500 | 1.583 | 3/4 | 8 |
| A 1C29-N24042 | A 1C29-Y24042 | 42 | 1.750 | 1.833 | | |
| A 1C29-N24048 | A 1C29-Y24048 | 48 | 2.000 | 2.083 | 3/4 | 8 |
| A 1C29-N24054 | A 1C29-Y24054 | 54 | 2.250 | 2.333 | | |
| A 1C29-N24060 | A 1C29-Y24060 | 60 | 2.500 | 2.583 | 3/4 | 8 |
| A 1C29-N24066 | A 1C29-Y24066 | 66 | 2.750 | 2.833 | | |
| A 1C29-N24072 | A 1C29-Y24072 | 72 | 3.000 | 3.083 | | |
| 20 Pitch | | | | | | |
| A 1C29-N20012 | A 1C29-Y20012 | 12 | .600 | .700 | 3/8 | 3 |
| A 1C29-N20014 | A 1C29-Y20014 | 14 | .700 | .800 | | |
| A 1C29-N20015 | A 1C29-Y20015 | 15 | .750 | .850 | 3/8 | 6 |
| A 1C29-N20016 | A 1C29-Y20016 | 16 | .800 | .900 | | |
| A 1C29-N20018 | A 1C29-Y20018 | 18 | .900 | 1.000 | 1/2 | 8 |
| A 1C29-N20020 | A 1C29-Y20020 | 20 | 1.000 | 1.100 | | |
| A 1C29-N20024 | A 1C29-Y20024 | 24 | 1.200 | 1.300 | 1/2 | 8 |
| A 1C29-N20030 | A 1C29-Y20030 | 30 | 1.500 | 1.600 | | |
| A 1C29-N20035 | A 1C29-Y20035 | 35 | 1.750 | 1.850 | 3/4 | 8 |
| A 1C29-N20040 | A 1C29-Y20040 | 40 | 2.000 | 2.100 | | |
| A 1C29-N20045 | A 1C29-Y20045 | 45 | 2.250 | 2.350 | 3/4 | 8 |
| A 1C29-N20050 | A 1C29-Y20050 | 50 | 2.500 | 2.600 | | |
| A 1C29-N20060 | A 1C29-Y20060 | 60 | 3.000 | 3.100 | | |